

**Kam Tai**

Professional  
High-Quality  
Threaded Rods

**KT  
02**





## About Us

Headquartered in Hong Kong, Kam Tai Products operates in China, Hong Kong and Macau, providing customers with innovative solutions and services on large-scale construction projects.

We are firmly committed to becoming the preferred metal cable containment and cabling system supplier.

## 關於我們

金泰製品總部設於香港，業務遍佈中國，香港及澳門，曾完成多項大型及優質的建築項目，並為客戶提供創新的方案及服務。我們致力成為客戶首選的金屬電纜保護系統及佈線系統供應商。

## What We Do

Kam Tai Products is dedicated to providing quality service and products. We aim to provide customers with a one-stop service using our series of products such as cable trunking, cable trays, cable ladders, cable baskets and U-channel supporting systems. We also supply all the necessary accessories and hardware to support cable containment installation such as threaded rod and screws. With more than 30 years of experience and skilled resources, we are able to deliver quality products that meets all customer needs.

## 專業

金泰製品致力提供優質的服務及優良的產品，我們為客戶提供一站式服務及一系列的電線槽、電纜托盤、承托骨架等產品，及提供安裝所需的螺絲杆及螺絲配件等配套用五金，憑藉超過三十年的經驗及資源，我們於每個工程項目均能準時為客戶交付優質而符合不同標準的產品。

## Our History

We first set up our initial factory in China during the late 90's and due to an increased production demand, moved to our expanded Huizhou factory at Guangdong, which has a production area of more than 20,000 square meters. With the advanced automation and bespoke machinery developed by our in-house research and development team combined with our efficient and highly skilled labour force, we have successfully reduced the cost of production and increased our production capability by more than 20 times since the opening of our first plant.

We are also continuing to invest, and strive to move toward with advanced automated robotic machines, we believe that our combined experience, automation plant and highly trained workforce can continue to provide reliable and high quality, effective and competitive products to our customers.

## 匯集優勢

我們早於上世紀九十年代在國內廣東省自設廠房，經過多年的發展及擴充，現於廣東省惠州市自設合共超過20,000平方米的生產基地，憑藉先進的自動化及自家研發設備，我們成功將勞動成本由高峰期的超過400人減少至現今的不足於80人，而產能提升至由最初設廠時的20倍。我們亦不斷繼續投資，透過軟件優化及購置更先進的自動化生產機器設備，提高生產量及速度以發揮更大的成本效益。我們相信，憑藉我們豐富的經驗及資源，我們能夠為客戶提供優質、快捷及具競爭力的產品。

 **03**

**Threaded Rod**

 **06**

**Channel Nut**

 **07**

**Accessories**



# Threaded Rod

Grade 4.8/8.8  
HDG/ZP Steel Threaded Rods 3000mm  
熱浸鉛水/鍍鋅絲杆 3米

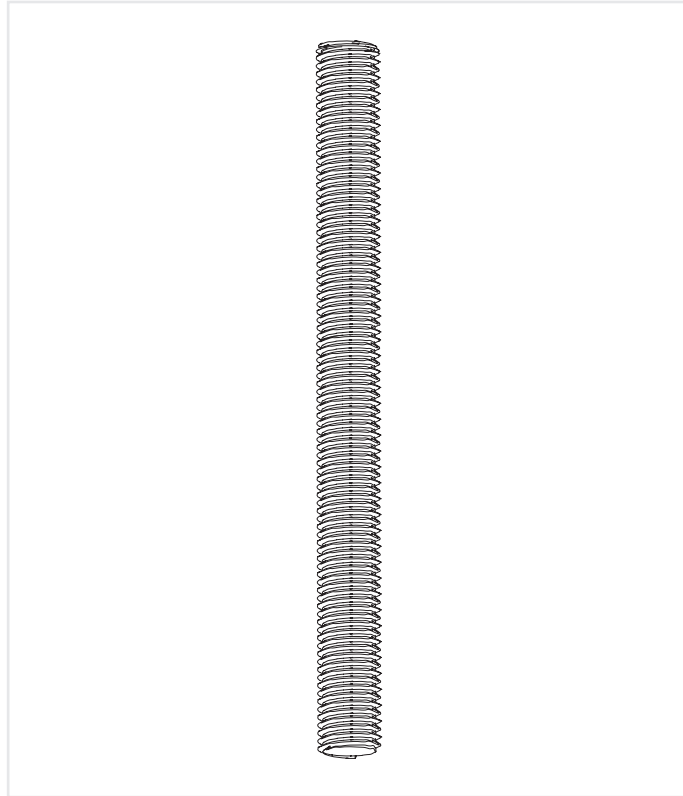

### Material Standard

Grade 4.8 & Grade 8.8  
to  
ISO 898 Part 1: 2009

### Material

Steel

### Finishing

Hot dip galvanized to ISO 1461:1999  
Zinc plated to BS 7371 - 12 : 2008

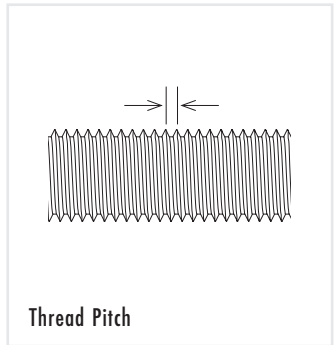

Thread Pitch

4.8 / 8.8 HDG / ZP Meter

Order example : HDG-8.8 M20x3000 (Order Code: 02033.200.300)

Size	Thread Pitch	02013	02001	02033	02031	Packing
		Grade 4.8 HDG 熱浸鉛水 4.8	Grade 4.8 ZP 鍍鋅 4.8	Grade 8.8 HDG 熱浸鉛水 8.8	Grade 8.8 ZP 鍍鋅 8.8	
M6	1.0	02013.060.300	02001.060.300		02031.060.300	50
M8	1.25	02013.080.300	02001.080.300		02031.080.300	25
M10	1.5	02013.100.300	02001.100.300	02033.100.300	02031.100.300	20
M12	1.75	02013.120.300	02001.120.300	02033.120.300	02031.120.300	10
M16	2.0	02013.160.300	02001.160.300	02033.160.300	02031.160.300	5
M20	2.5	02013.200.300	02001.200.300	02033.200.300	02031.200.300	5
M24	3.0	02013.240.300	02001.240.300	02033.240.300	02031.240.300	4
M27	3.0			02033.270.300	02031.270.300	2
M30	3.5			02033.300.300	02031.300.300	2
M33	3.5			02033.330.300	02031.330.300	1
M36	4.0			02033.360.300	02031.360.300	1
M39	4.0			02033.390.300		1
M42	4.5			02033.420.300		1
M45	4.5			02033.450.300		1
M48	5.0			02033.480.300		1
M52	5.0			02033.520.300		1



# Threaded Rod

Inch Size Steel Threaded Rods 3000mm  
英制絲杆 3米

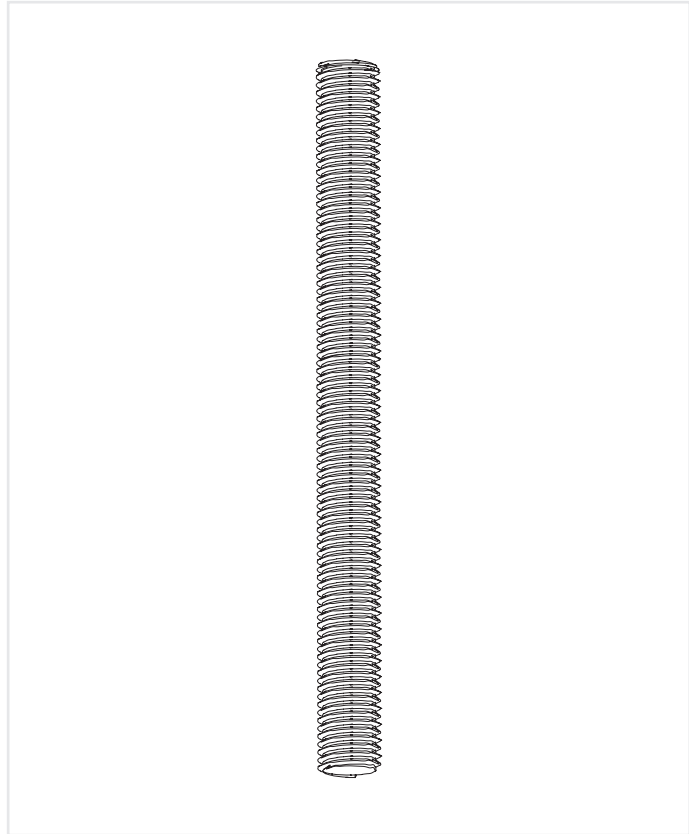

### Material Standard

Grade 4.8 & Grade 8.8  
to  
ISO 898 Part 1: 2009

### Material

Steel / Stainless Steel

### Finishing

Hot dip galvanized to ISO 1461:1999  
Zinc plated to BS 7371 - 12 : 2008

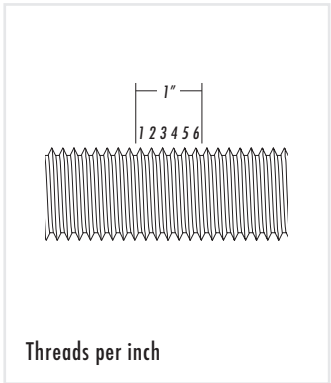

02001 (DIN 975 ZP) / 72002 (ST/ A2)

Order example : DIN 975 ZP Steel 1/4x3000 (Order Code : 02001.063.300)

Size	Threads per inch	Grade 4.8 ZP 鍍鋅 4.8	Stainless Steel 白鋼	Packing
1/4	20	02001.063.300	72002.063.300	50
5/16	18	02001.079.300	72002.079.300	25
3/8	16	02001.096.300	72002.096.300	20
1/2	12	02001.127.300	72002.127.300	10
5/8	11	02001.158.300	72002.158.300	5
3/4	10	02001.191.300	72002.191.300	5
1	8	02001.254.300	72002.254.300	4
1-1/4	7	02001.317.300		2
1-1/2	6	02001.381.300		1



# Threaded Rod

Grade SS304 / SS316 Threaded Rods 3000mm  
不鏽鋼 SS304 / SS316 絲杆 3米

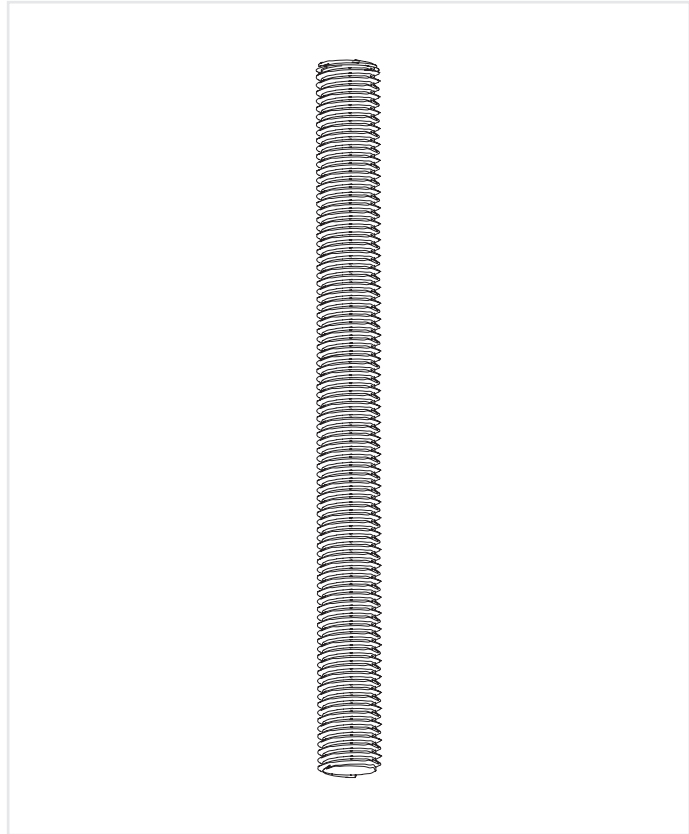

### Material Standard

Grade SS304 & SS316

### Material

Stainless Steel

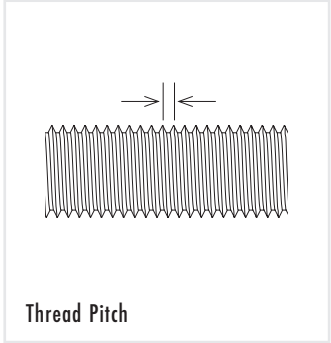

SS304 / SS316 Stainless Steel Meter

Order example : SS316 M20x3000 (Order Code : 00316.200.300)

Size	Thread Pitch	00304		00316		Packing
		Grade SS304 不鏽鋼 SS304	Grade SS316 不鏽鋼 SS316	Grade SS304 不鏽鋼 SS304	Grade SS316 不鏽鋼 SS316	
M6	1.0	00304.060.300	00316.060.300	00304.060.300	00316.060.300	50
M8	1.25	00304.080.300	00316.080.300	00304.080.300	00316.080.300	25
M10	1.5	00304.100.300	00316.100.300	00304.100.300	00316.100.300	20
M12	1.75	00304.120.300	00316.120.300	00304.120.300	00316.120.300	10
M16	2.0	00304.160.300	00316.160.200	00304.160.300	00316.160.200	5
M20	2.5	00304.200.300	00316.200.300	00304.200.300	00316.200.300	5
M24	3.0	00304.240.300	00316.240.300	00304.240.300	00316.240.300	4
M27	3.0					2
M30	3.5					2
M33	3.5					1
M36	4.0					1
M39	4.0					1
M42	4.5					1
M45	4.5					1
M48	5.0					1
M52	5.0					1



# Channel Nut

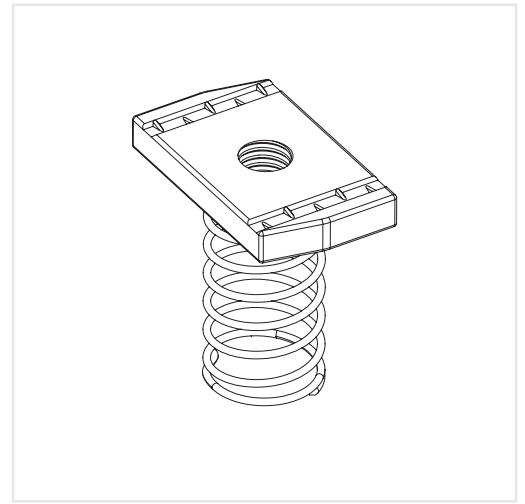
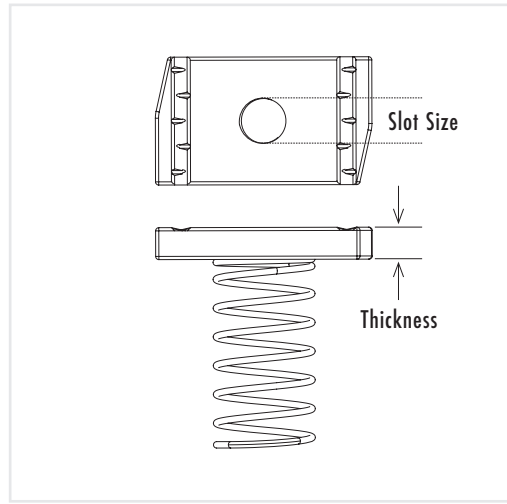

**Long Spring Nut**  
for 41 x 41mm U-Channel

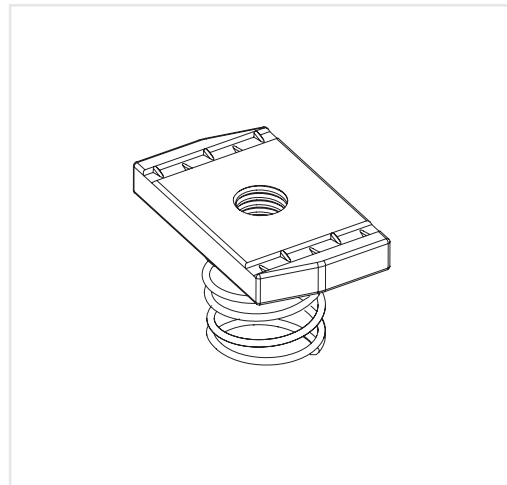

**Short Spring Nut**  
for 21 x 41mm U-Channel

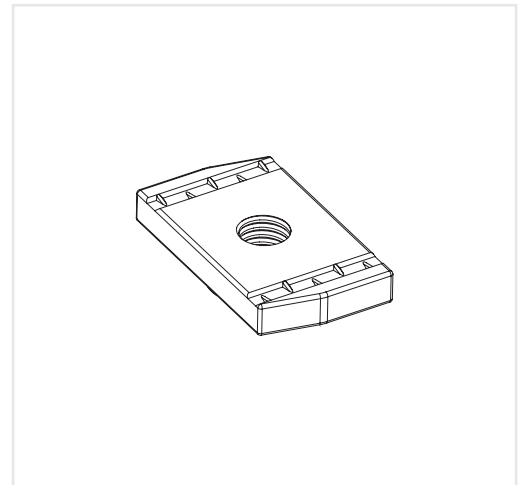

**Channel nut**  
for 21 x 41mm U-Channel

Slot Size	Standard Product Code			
	Thickness	Long Spring	Short Spring	Channel Nut
M6	5mm	LSC - 6	SSC - 6	CN - 6
M8	6mm	LSC - 8	SSC - 8	CN - 8
M10	8mm	LSC - 10	SSC - 10	CN - 10
M12	8mm	LSC - 12	SSC - 12	CN - 12
M16	12mm	LSC - 16	SSC - 16	CN - 16





## Accessories

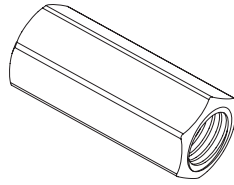

Product Code	Size
CPNM6	M6
CPNM8	M8
CPNM10	M10
CPNM12	M12

### Threaded Rod Coupling

Product Code

CPN + Size

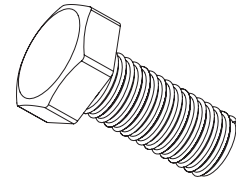

Product Code	Size
HSSM6	M6
HSSM8	M8
HSSM10	M10
HSSM12	M12

### Hex Set Screw

Product Code

HSS + Size

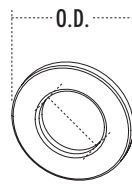

Product Code	Size	O.D.	
		for ZP/ HDG	for SS
FWM6	M6	19	12
FWM8	M8	22	15
FWM10	M10	25	20
FWM12	M12	32	23

### Flat Washer

Product Code

FW + Size

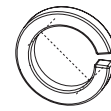

Product Code	Size
SWM6	M6
SWM8	M8
SWM10	M10
SWM12	M12

### Spring Washer

Product Code

SW + Size

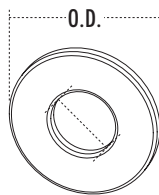

Product Code	Size	O.D.	
		for ZP/ HDG	for SS
SFWM6	M6	25	18
SFWM8	M8	30	25
SFWM10	M10	30	30

### Fender Washer

Product Code

SFW + Size

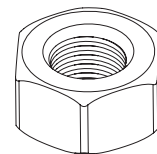

Product Code	Size
HN6	M6
HN8	M8
HN10	M10
HN12	M12

### Hex Nut

Product Code

HN + Size

#### Material Standard

Standard Size:

M5 / M6 / M8 / M10

M12 / M16 / M20

Grade 4.8 & Grade 8.8

to

ISO 898 Part 1: 2009

#### Material

Steel / SS

#### Finishing

Hot dip galvanized to ISO 1461:1999

Zinc plated to BS 7371 - 12 : 2008



# Accessories

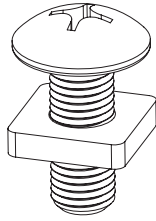

Product Code	Size
GBNM5	M5
GBNM6	M6
GBNM8	M8
GBNM10	M10

**Gutter Bolt & Square Nut**

*Product Code*

*GBN + Size*

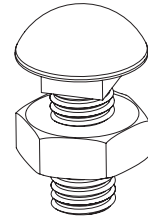

Product Code	Size
CSNM6	M6
CSNM8	M8
CSNM10	M10
CSNM12	M12

**Cup Square Bolt & Nut**

*Product Code*

*CSN + Size*



Product Code	Size
CPSM8	M8
CPSM10	M10
CPSM12	M12

**Cone Point Screw**

*Product Code*

*CPS + Size*

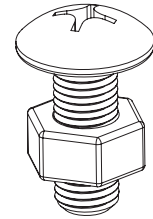

Product Code	Size
DHSM5	M5
DHSM6	M6
DHSM8	M8
DHSM10	M10

**Dome Head Slotted Bolt & Nut**

*Product Code*

*DHS + Size*

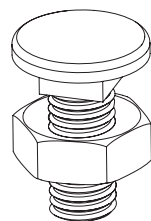

Product Code	Size
RNBM5	M5
RNBM6	M6
RNBM8	M8
RNBM10	M10

**Square Neck Round Head Bolt & Nut**

*Product Code*

*RNB + Size*

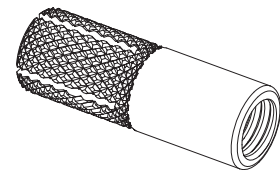

Product Code	Size
DAM8	M8
DAM10	M10
DAM12	M12

**Drop in Anchor**

*Product Code*

*DA + Size*

### Material Standard

Standard Size:

M5 / M6 / M8 / M10

M12 / M16 / M20

Grade 4.8 & Grade 8.8

to

ISO 898 Part 1: 2009

### Material

Steel / SS

### Finishing

Hot dip galvanized to ISO 1461:1999

Zinc plated to BS 7371 - 12 : 2008





Address G/F, Lung Shing Factory Bldg.,  
148 Texaco Road  
Tsuen Wan, N.T.,  
Hong Kong

Phone (852) 2407 8222

Fax (852) 2407 3000

Email [cs@ktp-hk.com](mailto:cs@ktp-hk.com)

Website [www.ktp-hk.com](http://www.ktp-hk.com)

