

Kam Tai

Cable Containment & Supporting Systems

Cable Trunking • Cable Tray • Cable Ladder
Cable basket • Floor Trunking System
U-Channel & Supporting • Threaded Rod & Screw

KT 01

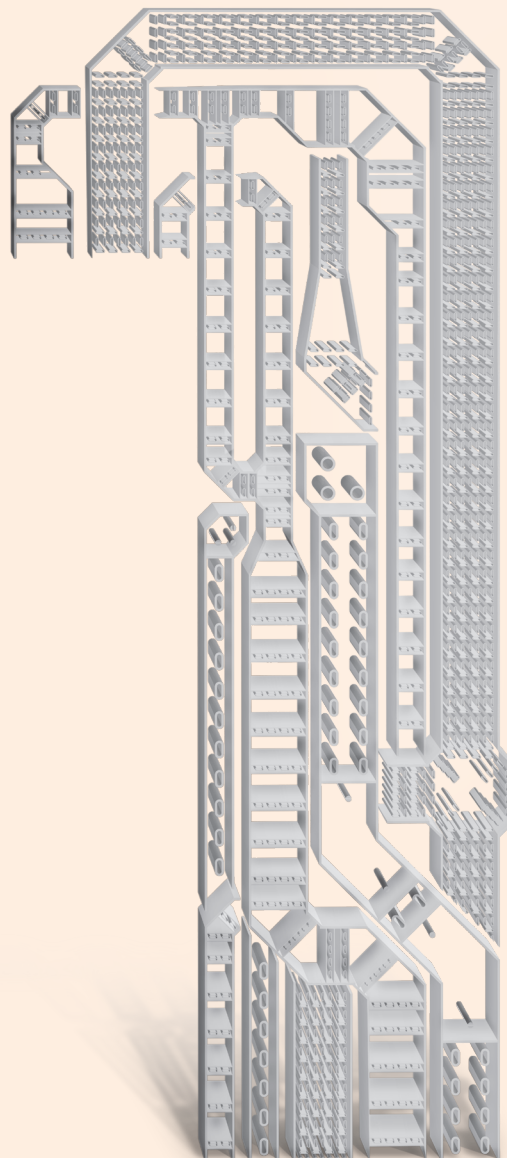

About Us

Headquartered in Hong Kong, Kam Tai Products operates in China, Hong Kong and Macau, providing customers with innovative solutions and services on large-scale construction projects.

We are firmly committed to becoming the preferred metal cable containment and cabling system supplier.

關於我們

金泰製品總部設於香港，業務遍佈中國，香港及澳門，曾完成多項大型及優質的建築項目，並為客戶提供創新的方案及服務。我們致力成為客戶首選的金屬電纜保護系統及佈線系統供應商。

What We Do

Kam Tai Products is dedicated to providing quality service and products. We aim to provide customers with a one-stop service using our series of products such as cable trunking, cable trays, cable ladders, cable baskets and U-channel supporting systems. We also supply all the necessary accessories and hardware to support cable containment installation such as threaded rod and screws. With more than 30 years of experience and skilled resources, we are able to deliver quality products that meets all customer needs.

專業

金泰製品致力提供優質的服務及優良的產品，我們為客戶提供一站式服務及一系列的電線槽、電纜托盤、承托骨架等產品，及提供安裝所需的螺絲杆及螺絲配件等配套用五金，憑藉超過三十年的經驗及資源，我們於每個工程項目均能準時為客戶交付優質而符合不同標準的產品。

Our History

We first set up our initial factory in China during the late 90's and due to an increased production demand, moved to our expanded Huizhou factory at Guangdong, which has a production area of more than 20,000 square meters. With the advanced automation and bespoke machinery developed by our in-house research and development team combined with our efficient and highly skilled labour force, we have successfully reduced the cost of production and increased our production capability by more than 20 times since the opening of our first plant.

We are also continuing to invest, and strive to move toward with advanced automated robotic machines, we believe that our combined experience, automation plant and highly trained workforce can continue to provide reliable and high quality, effective and competitive products to our customers.

匯集優勢

我們早於上世紀九十年代在國內廣東省自設廠房，經過多年的發展及擴充，現於廣東省惠州市自設合共超過20,000平方米的生產基地，憑藉先進的自動化及自家研發設備，我們成功將勞動成本由高峰期的超過400人減少至現今的不足於80人，而產能提升至由最初設廠時的20倍。我們亦不斷繼續投資，透過軟件優化及購置更先進的自動化生產機器設備，提高生產量及速度以發揮更大的成本效益。我們相信，憑藉我們豐富的經驗及資源，我們能夠為客戶提供優質、快捷及具競爭力的產品。

 **03**

Cable Trunking

 **11**

Cable Tray

 **15**

Cable Ladder

 **19**

U - Channel

 **29**

Cable & Pipe Clamps

 **31**

Finishes



Cable Trunking

電線槽

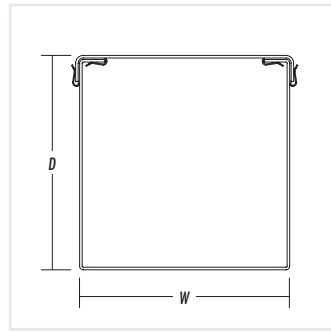

Spring Capped Fixed Cover
(夾仔蓋)
KT + / standard code+ / SF

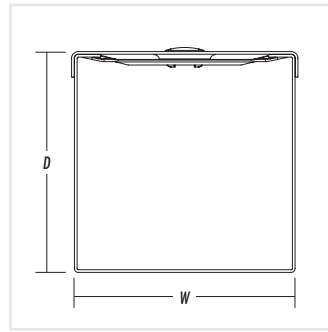

Turnbuckle Captive Screw Fixed Cover
(肚臍蓋)
KT + / standard code+ / QF

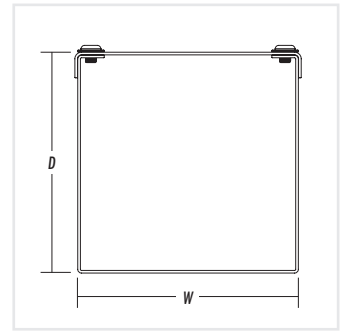

Screw Fixed Cover
(螺絲蓋)
KT+ / standard code+ / SO

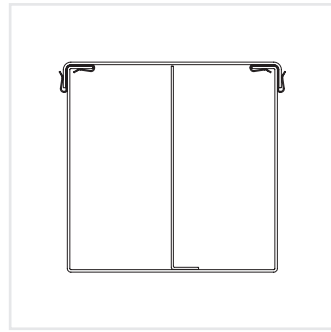

Two – Compartment
(分雙格)
KT + / standard code+ / 2C

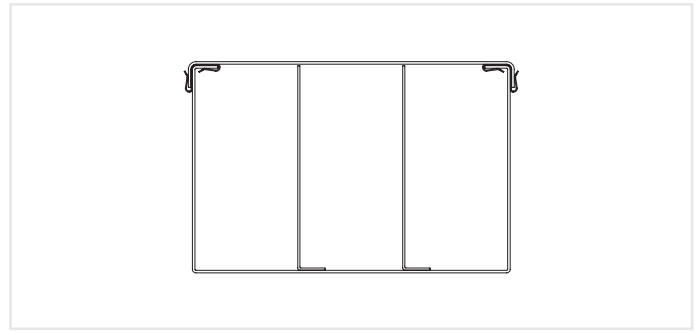

Three – Compartment
(分三格)
KT + / standard code+ / 3C

Technical Specification:

- BS EN50085-1 or IEC61084-1
- Each length supplied with cover, coupler, tinned earth link and fixing screws.
- Standard length is 2.44m/ Non standard thickness and finishes available to clients order.
- Customize size is available for order upon request.
- Materials Standard:
 - Galvanized Steel Sheet to BS4678
Part 1: Class 3 Protection to BS EN10143 (Coating Mass 275g/m²)
Standard product code +/GI
 - Mild Steel Sheet to BS1449-1 or BS EN10149-1 finished in Hot-dipped Galvanized after Perforation to ISO1461
Standard product code +/HDG

- Stainless Steel to Grade 304 or Grade 316
Standard product code +/SS304 or +/SS316

- Other Material or Coating:
 - Aluminum Steel Sheet
 - Plastic Coated
 - Epoxy / Polyester Powder Coated

Standard Size (mm) W x D	Available Material Thickness (mm)	Standard Code
50 x 50	1.0 / 1.2 / 1.4 / 1/6	5050
75 x 50	1.2 / 1.4 / 1.6	7550
75 x 75	1.2 / 1.4 / 1.6	7575
100 x 50	1.2 / 1.4 / 1.6	1050
100 x 75	1.2 / 1.4 / 1.6	1075
100 x 100	1.2 / 1.4 / 1.6	1010
150 x 50	1.2 / 1.4 / 1.6	1550
150 x 75	1.2 / 1.4 / 1.6 / 1.8	1575
150 x 100	1.2 / 1.4 / 1.6 / 1.8	1510
150 x 150	1.2 / 1.4 / 1.6 / 1.8	1515
200 x 50	1.2 / 1.4 / 1.6 / 1.8	2050
200 x 75	1.2 / 1.4 / 1.6 / 1.8	2075
200 x 100	1.2 / 1.4 / 1.6 / 1.8	2010
200 x 150	1.2 / 1.4 / 1.6 / 1.8	2015
200 x 200	1.4 / 1.6 / 1.8 / 2.0	2020
250 x 100	1.4 / 1.6 / 1.8 / 2.0	2510
250 x 150	1.4 / 1.6 / 1.8 / 2.0	2515
250 x 200	1.4 / 1.6 / 1.8 / 2.0	2520
250 x 250	1.4 / 1.6 / 1.8 / 2.0	2525
300 x 100	1.4 / 1.6 / 1.8 / 2.0	3010
300 x 150	1.4 / 1.6 / 1.8 / 2.0	3015
300 x 200	1.4 / 1.6 / 1.8 / 2.0	3020
300 x 300	1.4 / 1.6 / 1.8 / 2.0	3030
400 x 100	1.4 / 1.6 / 1.8 / 2.0	4010
400 x 150	1.4 / 1.6 / 1.8 / 2.0	4015
400 x 200	1.4 / 1.6 / 1.8 / 2.0	4020
400 x 250	1.4 / 1.6 / 1.8 / 2.0	4025
400 x 300	1.4 / 1.6 / 1.8 / 2.0	4030
400 x 400	1.4 / 1.6 / 1.8 / 2.0	4040



**Trunking
Fitting**
電線槽配件

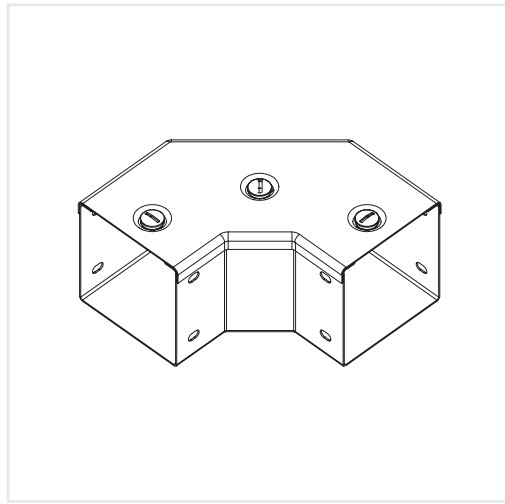

90 degree Front Opening Bend
(90度 大面曲)
B + / standard code

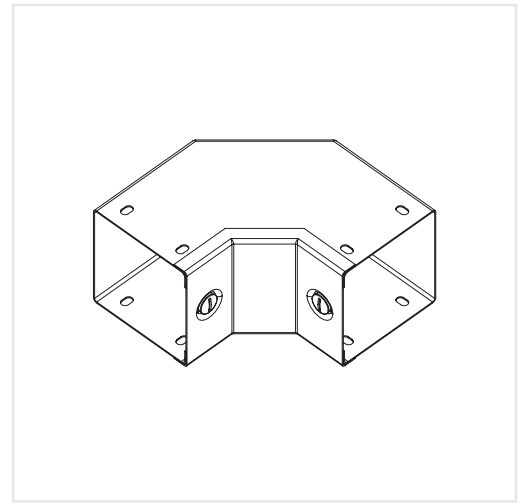

90 degree Internal Opening Bend
(90度 內曲)
IB + / standard code

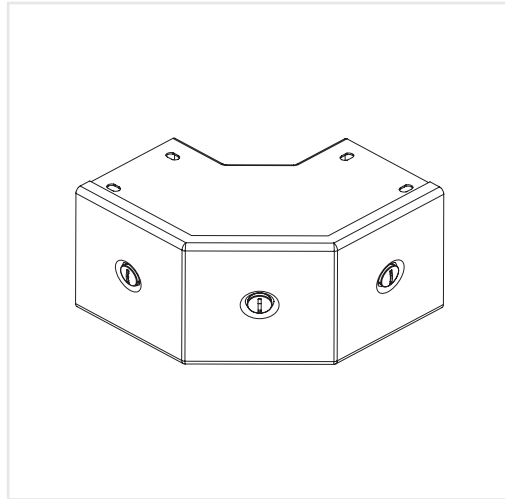

90 degree External Opening Bend
(90度 外曲)
EB + / standard code

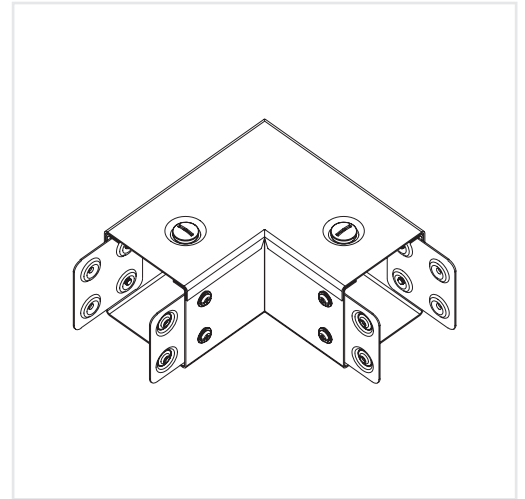

90 degree Front Opening Elbow
(90度 直角面曲)
EBF + / standard code

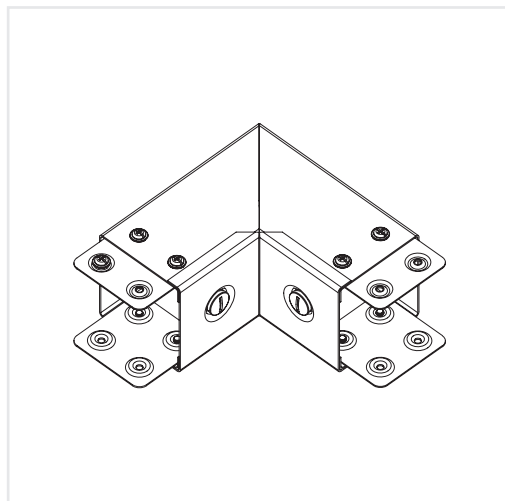

90 degree Internal Opening Elbow
(90度 直角內曲)
EBI + / standard code

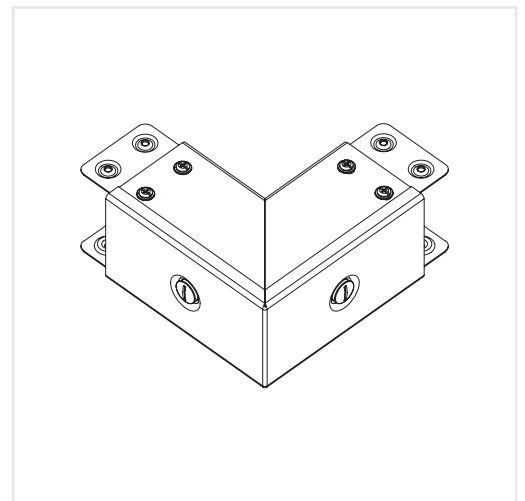

90 degree External Opening Elbow
(90度 直角外曲)
EBE + / standard code

Thickness of fittings corresponds to trunking



Trunking Fitting

電線槽配件

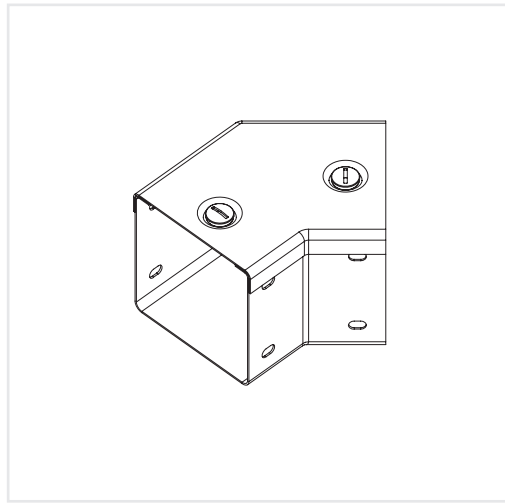

45 degree Front Opening Bend
(45度 面曲)
FB + / standard code

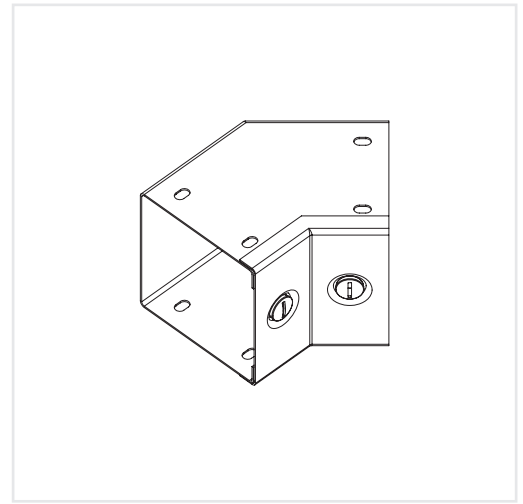

45 degree Internal Opening Bend
(45度 內曲)
FIB + / standard code

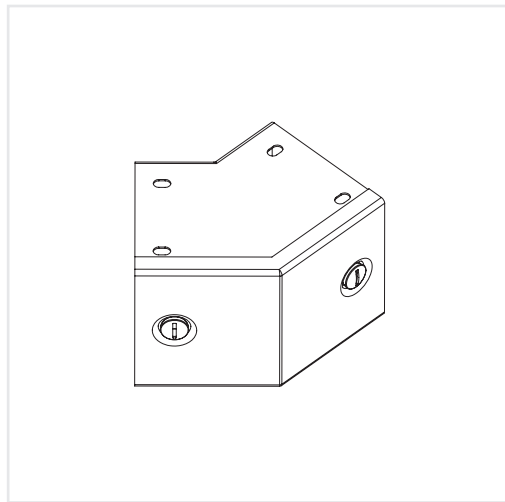

45 degree External Opening Bend
(45度 外曲)
FEB + / standard code

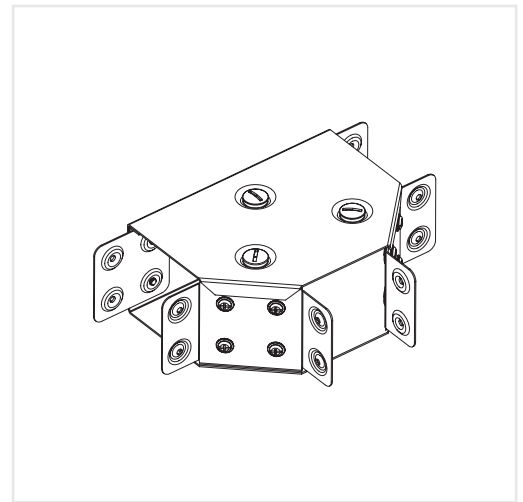

Front Opening Tee
(大面T)
T + / standard code

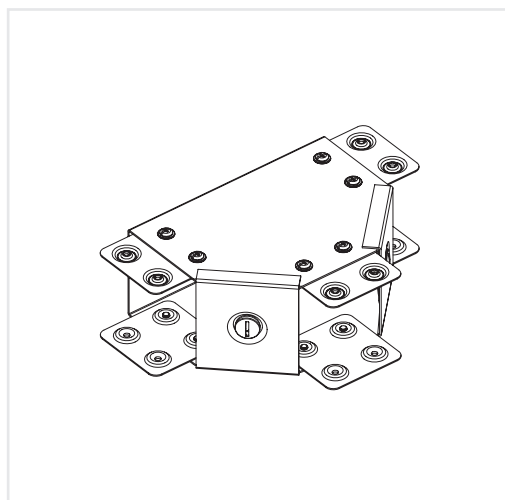

Internal Opening Tee
(細蓋T)
IT + / standard code

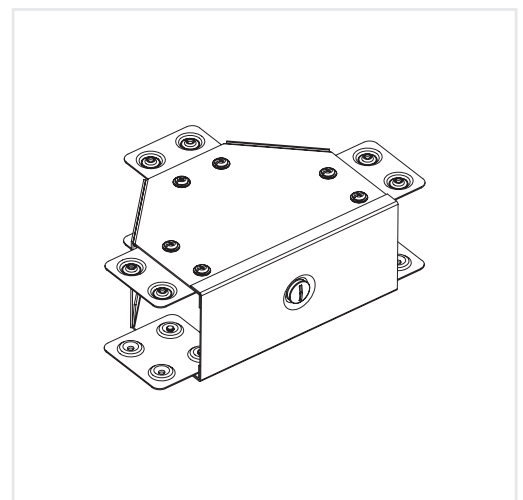

External Opening Tee
(頂蓋T)
ET + / standard code



Trunking Fitting

電線槽配件

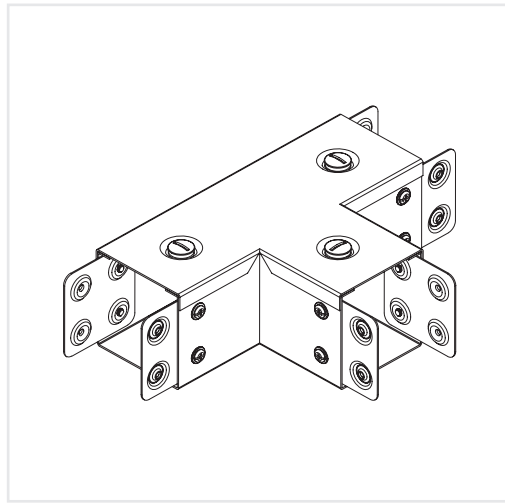

Front Opening Elbow Tee
(直角大面T)
TTF + / standard code

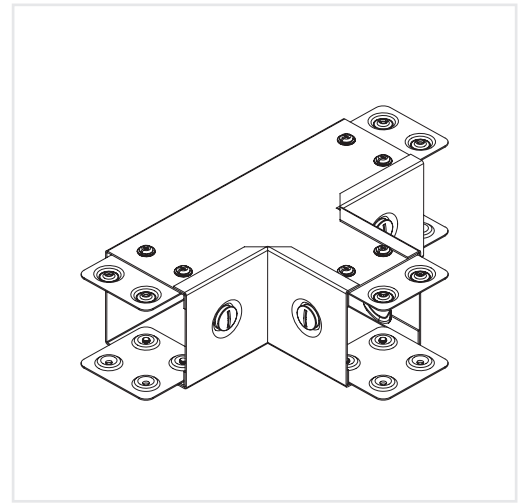

Internal Opening Elbow Tee
(直角細蓋T)
TTI + / standard code

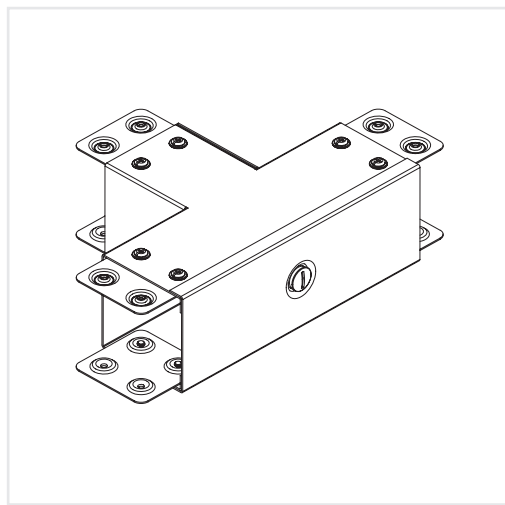

External Opening Elbow Tee
(直角頂蓋T)
TTE + / standard code

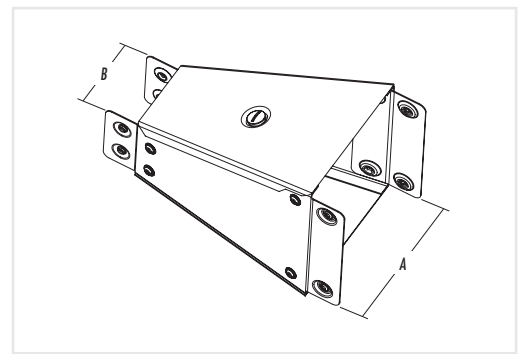

Reducer (直刁士)
+ / size A + / size B

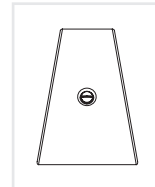

Centre (KTC)
(直刁)

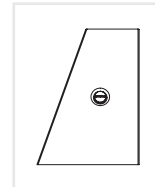

Left side (KTLH)
(左斜)

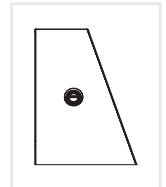

Right side (KTRH)
(右斜)

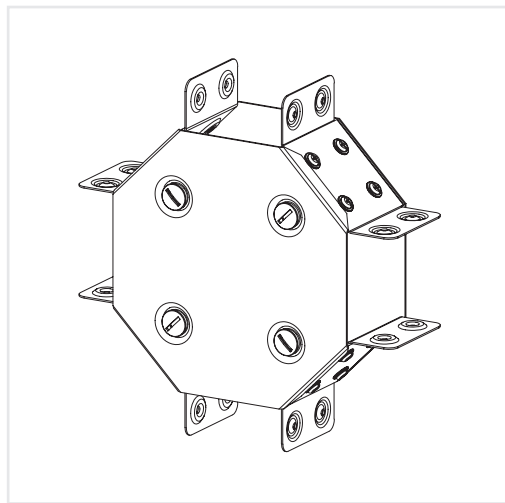

Front Opening Cross (大面十字)
CR + / standard code

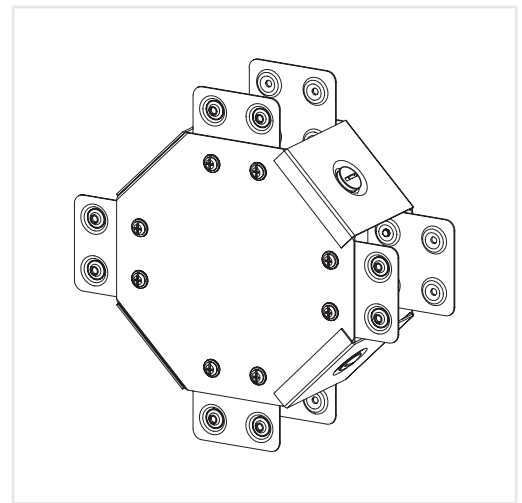

Outside Opening Cross (細蓋十字)
SC + / standard code

Product Code i.e.:

100 x 100mm, 1.4mm thk. galvanized steel, spring capped fixed cover trunking
= KT/1010/SF/1.4/GI

100 x 100mm, 1.4mm thk. galvanized steel, spring capped fixed cover trunking, two-compartment
= KT/1010/SF/1.4/GI/2C



**Special Trunking
Fitting
特製配件**

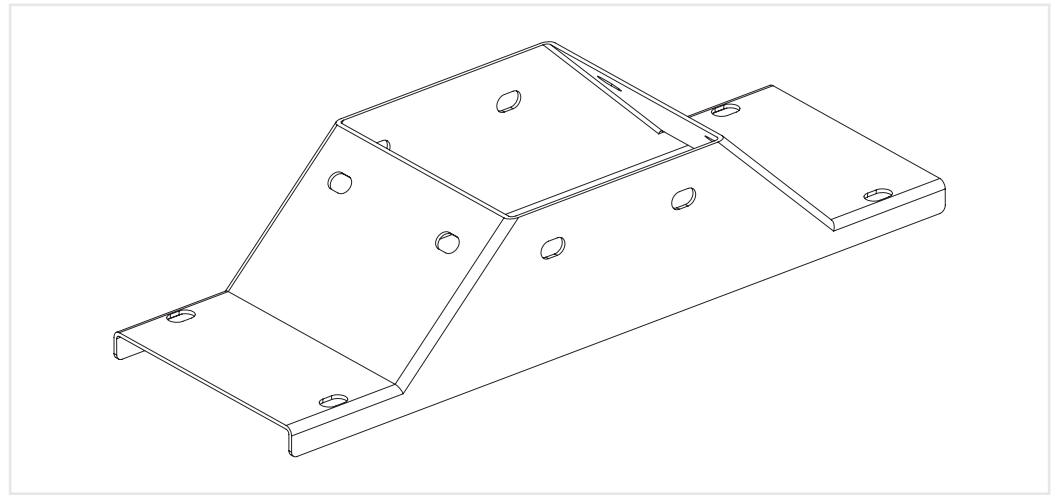

Cover Tee (直出蓋T)

Remark: for 2 compartment Cover Tee: Standard Product Code + / 2

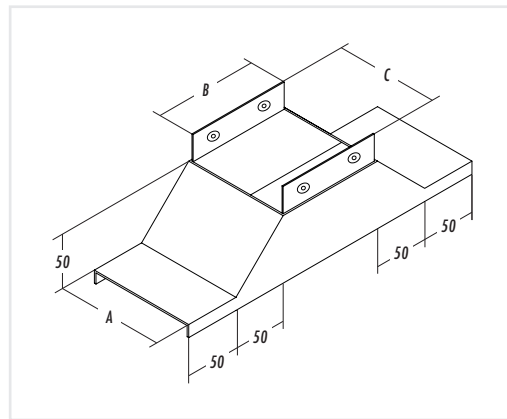

Type A

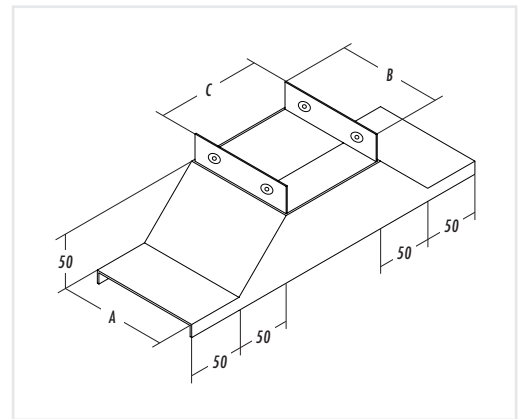

Type B

Size in mm A x B x C	Standard Product Code Type A	Standard Product Code Type B
50 x 50 x 50	CTA222	CTB222
75 x 50 x 50	CTA322	CTB322
75 x 50 x 75	CTA323	CTB323
75 x 75 x 75	CTA333	CTB333
100 x 50 x 50	CTA422	CTB422
100 x 50 x 75	CTA423	CTB423
100 x 50 x 100	CTA424	CTB424
100 x 75 x 75	CTA433	CTB433
100 x 75 x 100	CTA434	CTB434
100 x 100 x 100	CTA444	CTB444
150 x 75 x 75	CTA633	CTB633
150 x 75 x 100	CTA634	CTB634
150 x 100 x 100	CTA644	CTB644
150 x 150 x 150	CTA666	CTB666
200 x 75 x 75	CTA833	CTB833
200 x 100 x 100	CTA844	CTB844
200 x 100 x 150	CTA846	CTB846
200 x 100 x 200	CTA848	CTB848
200 x 150 x 200	CTA868	CTB868
200 x 200 x 200	CTA888	CTB888
300 x 150 x 150	CTA1266	CTB1266
300 x 200 x 200	CTA1288	CTB1288
300 x 200 x 300	CTA12812	CTB12812
300 x 300 x 300	CTA121212	CTB121212

Thickness of fitting correspond to trunking



**Special Trunking
Fitting
特製配件**

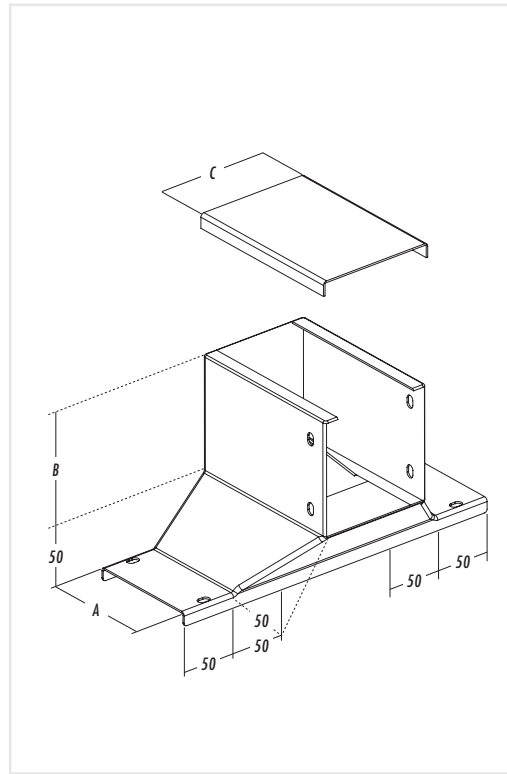

Change Face Cover Tee 轉面槽蓋T

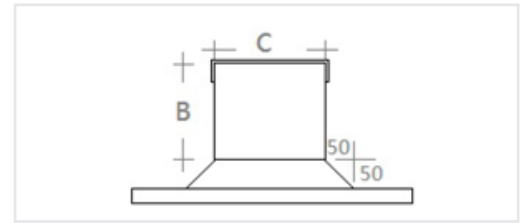

Front 正面 (Type A)

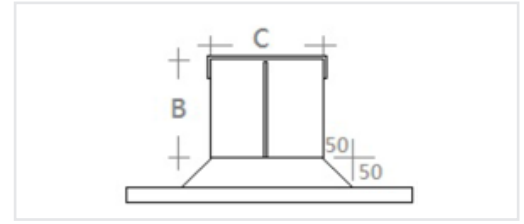

Front 正面 (Type B)

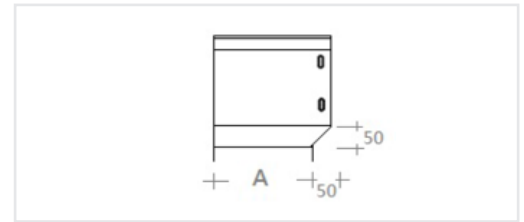

Side 側面 (Type A or B)

Size in mm A x B x C	Standard Product Code for 1/C 單格 Type A	Standard Product Code for 2/C 孖格 Type B
50 x 50 x 50	CFA222	CFB222
75 x 50 x 50	CFA322	CFB322
75 x 50 x 75	CFA323	CFB323
75 x 75 x 75	CFA333	CFB333
100 x 50 x 50	CFA422	CFB422
100 x 50 x 75	CFA423	CFB423
100 x 50 x 100	CFA424	CFB424
100 x 75 x 75	CFA433	CFB433
100 x 75 x 100	CFA434	CFB434
100 x 100 x 100	CFA444	CFB444
150 x 75 x 75	CFA633	CFB633
150 x 75 x 100	CFA634	CFB634
150 x 100 x 100	CFA644	CFB644
150 x 100 x 150	CFA646	CFB646
150 x 150 x 150	CFA666	CFB666
200 x 75 x 75	CFA833	CFB833
200 x 100 x 100	CFA844	CFB844
200 x 100 x 150	CFA846	CFB846
200 x 100 x 200	CFA848	CFB848
200 x 150 x 200	CFA868	CFB868
200 x 200 x 200	CFA888	CFB888
300 x 150 x 150	CFA1266	CFB1266
300 x 200 x 200	CFA1288	CFB1288
300 x 200 x 300	CFA12812	CFB12812
300 x 300 x 300	CFA121212	CFB121212



Accessories 配件

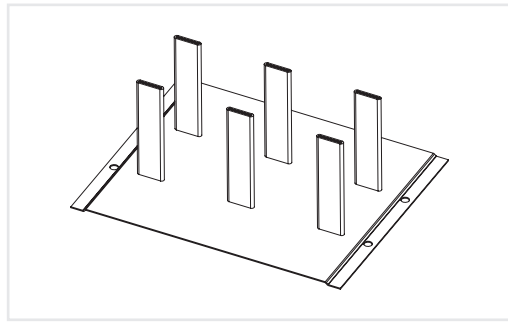

Pin Rack with Plastic Cover 線掛
DPR / (Size)

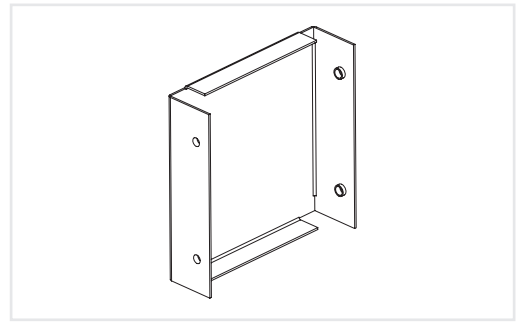

End Stop 槽尾封
EC / (Size)

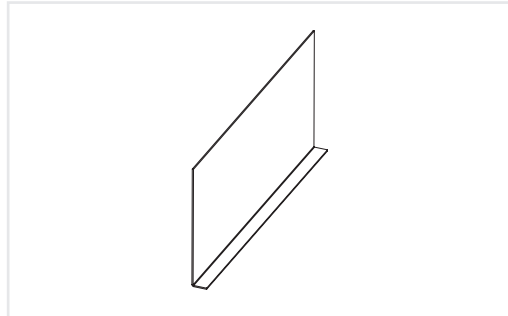

Divider (1mm) 槽隔片
DIV / (Size)

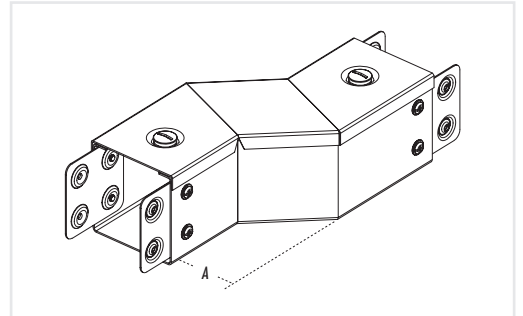

Horizontal Offset 水平之字
HOR / (Size)

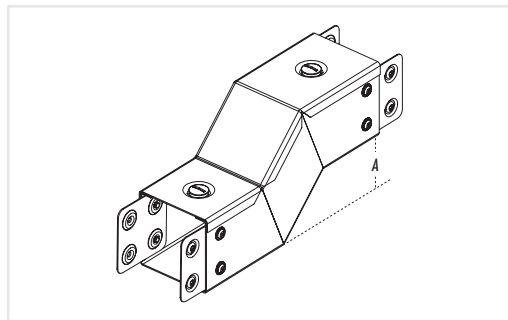

Vertical Offset 高低之字
VO / (Size)

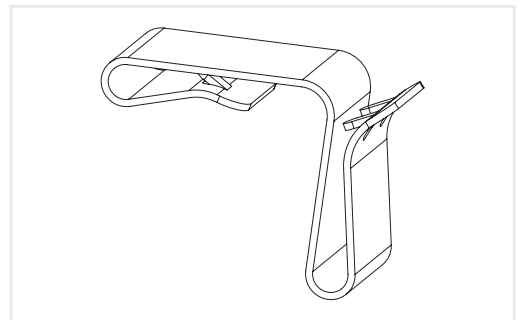

Spring Cap 槽夾
S / (Size)

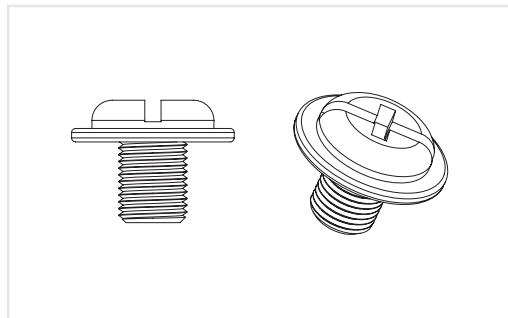

Flange Screw 槽駁螺絲
KFS / M5 Size or Other Size

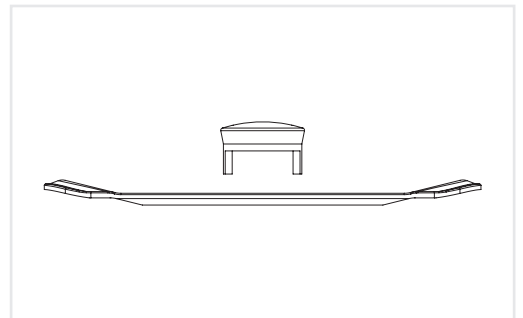

Quick Fix Bar with Copper Screw 銅頭
Q / (Size)

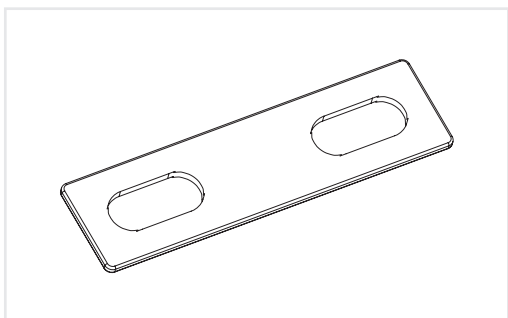

Copper Earth Link 水線片
COP / (Size)

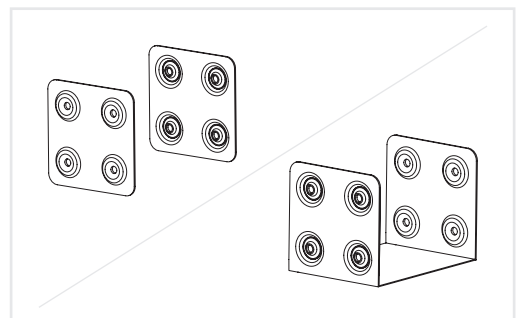

Trunking Coupler 槽駁片 or U-Shaped Connector U型駁口
C / (Size) or UC / (Size)



Cable Capacity Charts

The following information will assist you to select trunking size for the required number and size of cables in your installation.

Cable Table	Solid	Stranded	Solid	Stranded	Solid	Stranded	Solid	Stranded	Solid	Stranded	Solid	Stranded	Solid	Stranded	Solid	Stranded
Nominal Conductor Sizes mm ²	1.5	1.5	2.5	2.5	4	6	10	16	25	35	50	70	95	120	150	240
Factor Copper or Aluminum	7.1	8.1	10.2	11.4	15	22	38	50	75	95	133	177	277	284	346	552

To Determine Trunking Size:

Using the cable table above, multiply the quantities of each size of cable by appropriate factors, to determine the capacity units required. Then using the trunking size table below, select the trunking size which has the nearest higher capacity figure.

EXAMPLE:

What trunking size is needed to run 24 x 16mm² cable and 36mm² x 6mm cables? Using the trunking size table below, the trunking size required is 100 x 50 as this has the next higher figure for capacity units.

Quantity Factor	=	Subtotal
24 x 50	=	1,200
36 x 22	=	792
	Total	1,992

Trunking Size Table

These table are based on theoretical calculation and must be taken only as guide, due regard must be taken of future wiring needs. These figures are based on the I.E.E. regulations.

Trunking Sizes (mm)	Capacity units
50 x 50	1037
75 x 50	1555
75 x 75	2371
100 x 50	2091
100 x 75	3189
100 x 100	4252
150 x 50	3091
150 x 75	4742
150 x 100	6394
150 x 150	9697
225 x 50	4646
225 x 75	7114
225 x 100	9298
225 x 150	14652
225 x 225	21766
300 x 50	6182
300 x 75	9486
300 x 100	12788
300 x 150	19447
300 x 300	38894



Span of Support

Spacing of Support for Cable Trunking

Notes:

- a) The span assumes that the trunking is not exposed to mechanical stresses other than due to the weight of the enclosed cables and the trunking and the fittings.
- b) The above figures do not apply to trunking which is used for supporting luminaries or other equipment.

Cross – sectional area of trunking	Maximum distance between supports steel trunking - Horizontal	Maximum distance between supports steel trunking - Vertical
(a) Up to 2500mm ²	1.25 m	1.50 m
(b) Exceeding 2500mm ² but not exceeding 6000mm ²	1.75 m	2.00 m
(c) Exceeding 6000mm ² but not exceeding 10000mm ²	2.30 m	2.50 m
(d) Exceeding 10000mm ²	3.00 m	3.00 m



**Cable
Tray**
電纜托盤

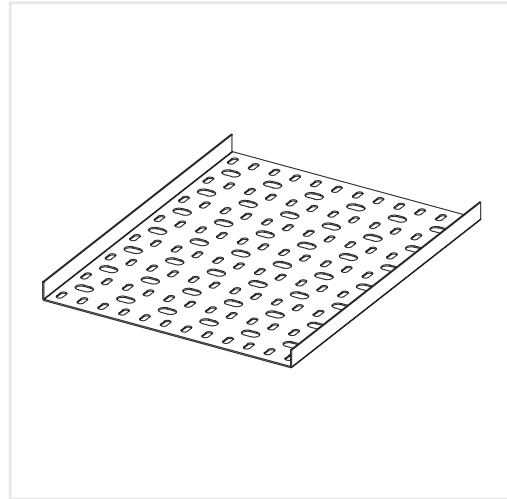
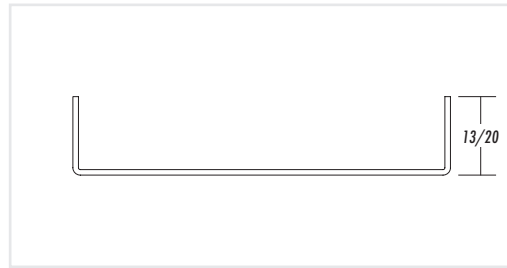

CT Series 單摺邊
Light duty with single edge
13mm upstand to under 300mm (W)
20mm upstand to 300mm (W) or over
Standard code
CT / width / thickness

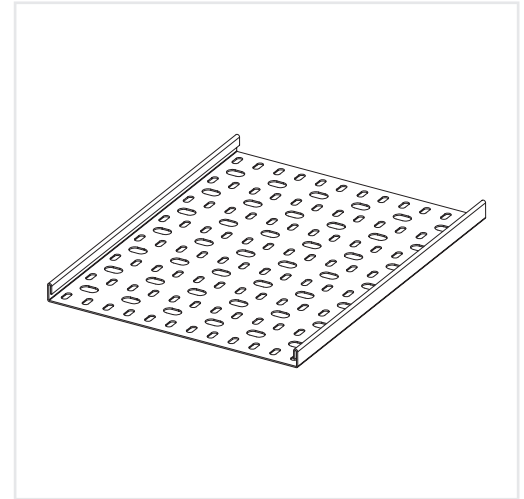

RCT Series 20/12 雙摺邊
Heavy duty with return edge
20mm upstand with 12mm return edge
Standard code
RCT / width / thickness

Technical Specification:

- BS EN61537 or IEC61537 to class 5
- Each length supplied with coupler, tinned earth link and fixing screws.
- Standard length is 2.44m/ Non standard thickness and finishes available to clients order.
- Customize size is available for order upon request.

Materials Standard:

- Galvanized Steel Sheet to BS4678
Part 1: Class 3 Protection to BS EN10143
(Coating Mass 275g/m²)
Standard product code +/GI
- Mild Steel Sheet to BS1449-1 or BS EN10149-1 finished in Hot-dipped Galvanized after Perforation to ISO1461
Standard product code +/HDG
- Stainless Steel to Grade 304 or Grade 316
Standard product code +/SS304 or +/SS316

Other Material or Coating:

- Aluminum Steel Sheet
- Plastic Coated
- Epoxy / Polyester Powder Coated

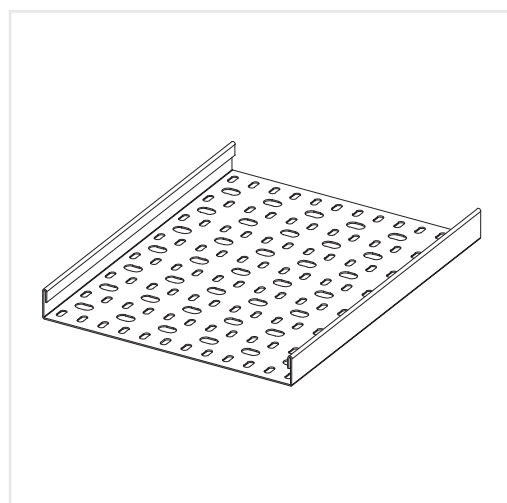
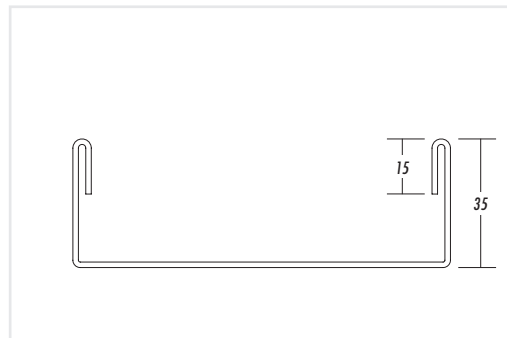

HCT Series 35/15 雙摺邊
Heavy duty with return edge
35mm upstand with 15mm return edge
Standard code
HCT / width / thickness

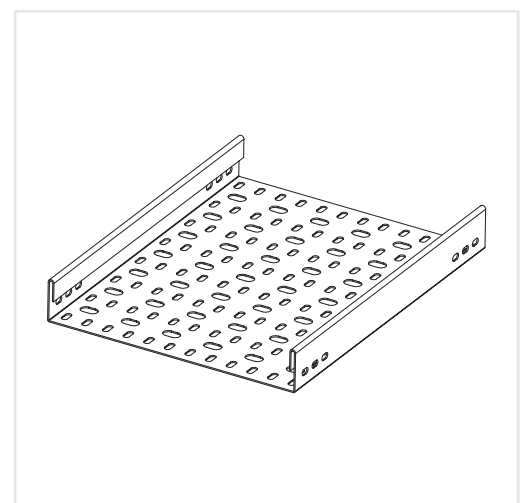
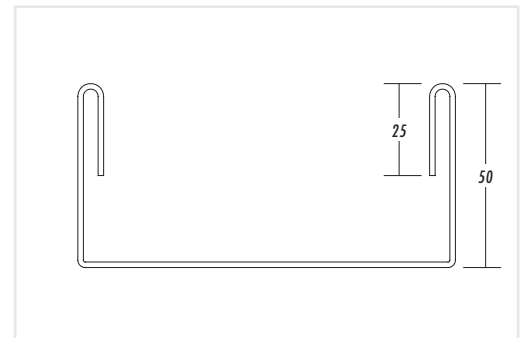

HCT+ Series 50/25 雙摺邊
Extra Heavy duty with return edge
50mm upstand with 25mm return edge
Standard code
HCT / width / thickness-x



Tray Fitting 電纜托盤配件

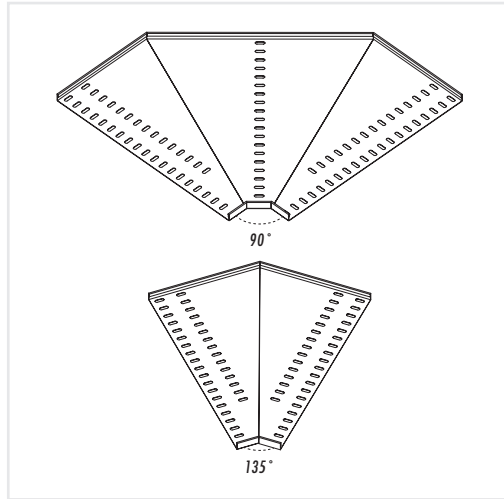

90 Deg / 135 Deg Bends 90度 / 135度大曲面

Basic Code

CT Series – CTB, RCT Series – RCTB

HCT Series – HCTB, HCT + Series HCTBx

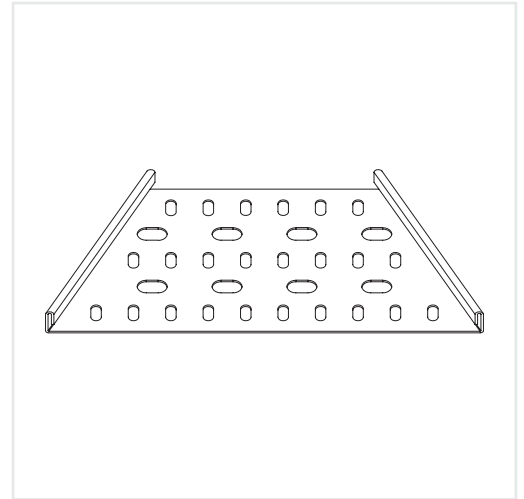

Reducer 直刁士

Basic Code

CT Series – CTR, RCT Series – RCTR

HCT Series – HCTR, HCT+ Series – HCTRx

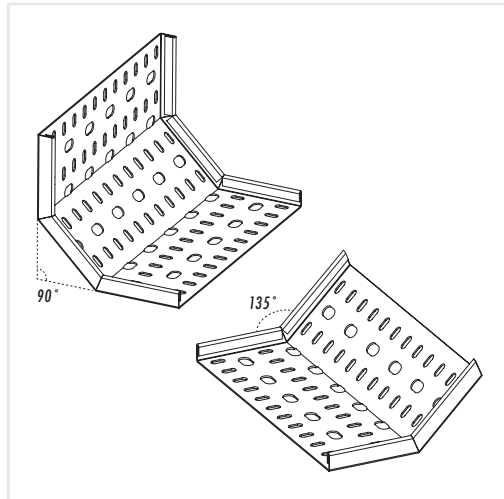

90 Deg / 135 Deg Internal Riser 90度 / 135度內曲

Basic Code

CT Series – CTI, RCT Series – RCTI

HCT Series – HCTI, HCT + Series HCTIx

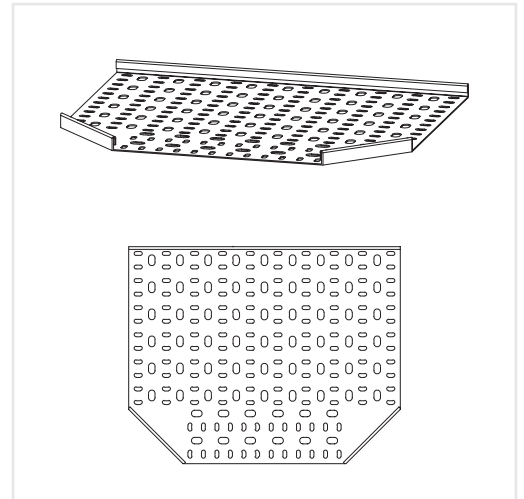

Tees 三叉

Basic Code

CT Series – CTT, RCT Series – RCTT

HCT Series – HCTT, HCT + Series HCTTx

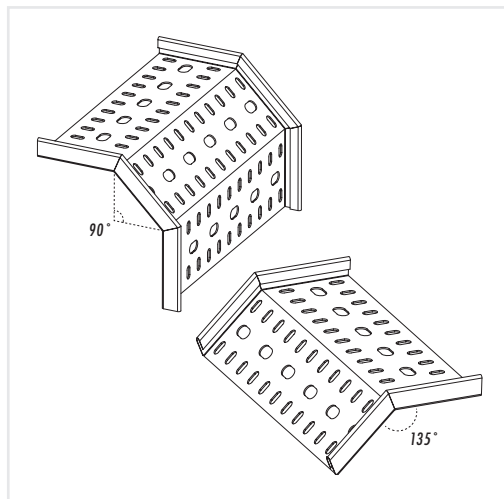

90 Deg / 135 Deg External Riser 90度 / 135度外曲

Basic Code

CT Series – CTE, RCT Series – RCTE

HCT Series – HCTE, HCT + Series HCTEx

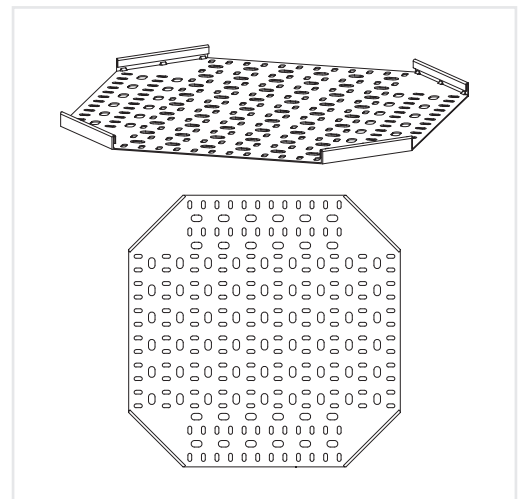

Cross 十字叉

Basic Code

CT Series – CTC, RCT Series – RCTC

HCT Series – HCTC, HCT + Series HCTCx

Cable Tray Standard Width and Thickness

Slotted Hole Detail

C/C of each slots: 25mm

Big slot size: 20 x 11mm

Small slot size: 20 x 8mm

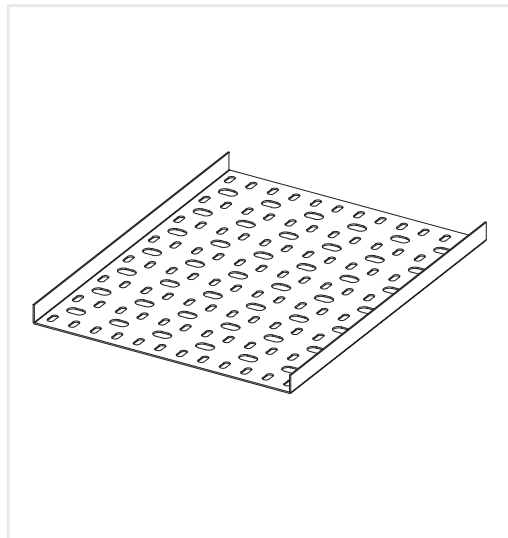

Standard Product Code, i.e.:

100mm x 1.2mm thk, single edge cable tray 2.44m, hot-dipped galvanized after perforation
= CT/100/1.2/HDG

100mm x 1.2mm thk, single edge 90 degree bend, hot-dipped galvanized after perforation
= CTB/100/90°

Standard Width (mm)	Available Material Thickness (mm)
50	1.2 / 1.5 / 1.6 / 2.0
75	1.2 / 1.5 / 1.6 / 2.0
100	1.2 / 1.5 / 1.6 / 2.0
150	1.2 / 1.5 / 1.6 / 2.0
200	1.2 / 1.5 / 1.6 / 2.0
225	1.2 / 1.5 / 1.6 / 2.0
250	1.2 / 1.5 / 1.6 / 2.0
300	1.2 / 1.5 / 1.6 / 2.0
350	1.2 / 1.5 / 1.6 / 2.0
400	1.2 / 1.5 / 1.6 / 2.0
450	1.2 / 1.5 / 1.6 / 2.0
500	1.2 / 1.5 / 1.6 / 2.0
550	1.2 / 1.5 / 1.6 / 2.0
600	1.2 / 1.5 / 1.6 / 2.0
650	1.2 / 1.5 / 1.6 / 2.0
700	1.2 / 1.5 / 1.6 / 2.0
750	1.2 / 1.5 / 1.6 / 2.0
800	1.2 / 1.5 / 1.6 / 2.0
850	1.2 / 1.5 / 1.6 / 2.0
900	1.2 / 1.5 / 1.6 / 2.0
950	1.2 / 1.5 / 1.6 / 2.0
1000	1.2 / 1.5 / 1.6 / 2.0
1050	1.2 / 1.5 / 1.6 / 2.0
1100	1.2 / 1.5 / 1.6 / 2.0
1150	1.2 / 1.5 / 1.6 / 2.0
1200	1.2 / 1.5 / 1.6 / 2.0



Method of Jointing

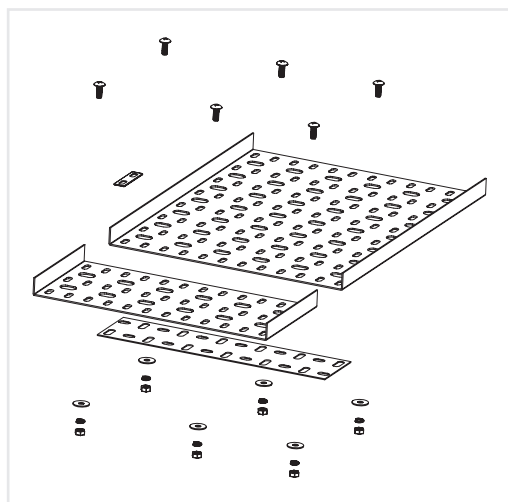

Bottom Jointing

CT / RCT / HCT Series

Tray Width	A	No. of Bolts Required
50	45	4
75	70	4
100	95	4
150	145	4
200	195	4
300	295	6
450	395	6
600	595	8
750	745	8
900	895	8

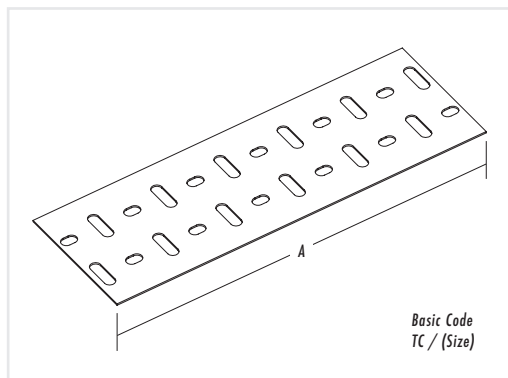

Basic Code
TC / (Size)



Method of Jointing

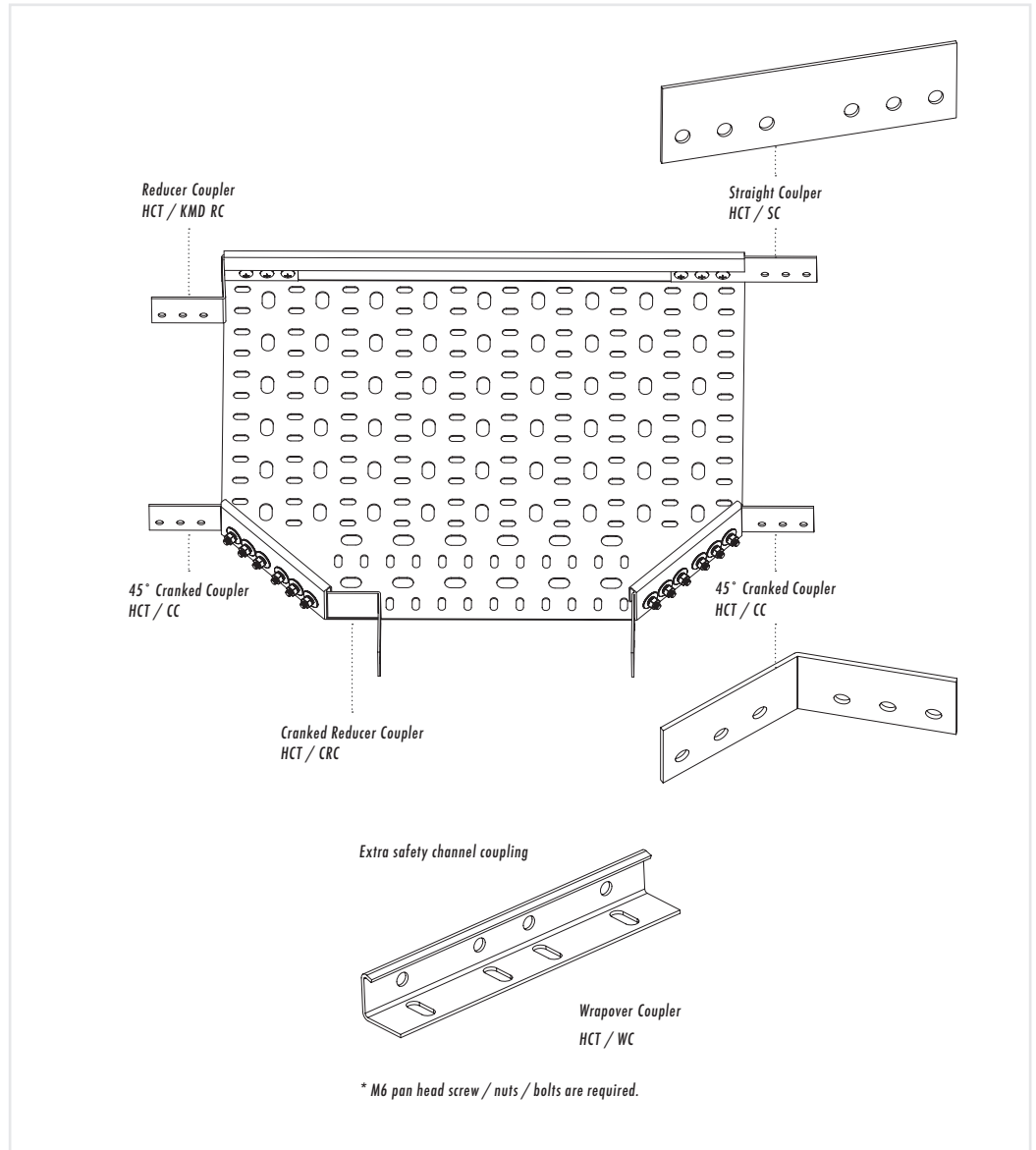

Side Jointing HCT+ Series

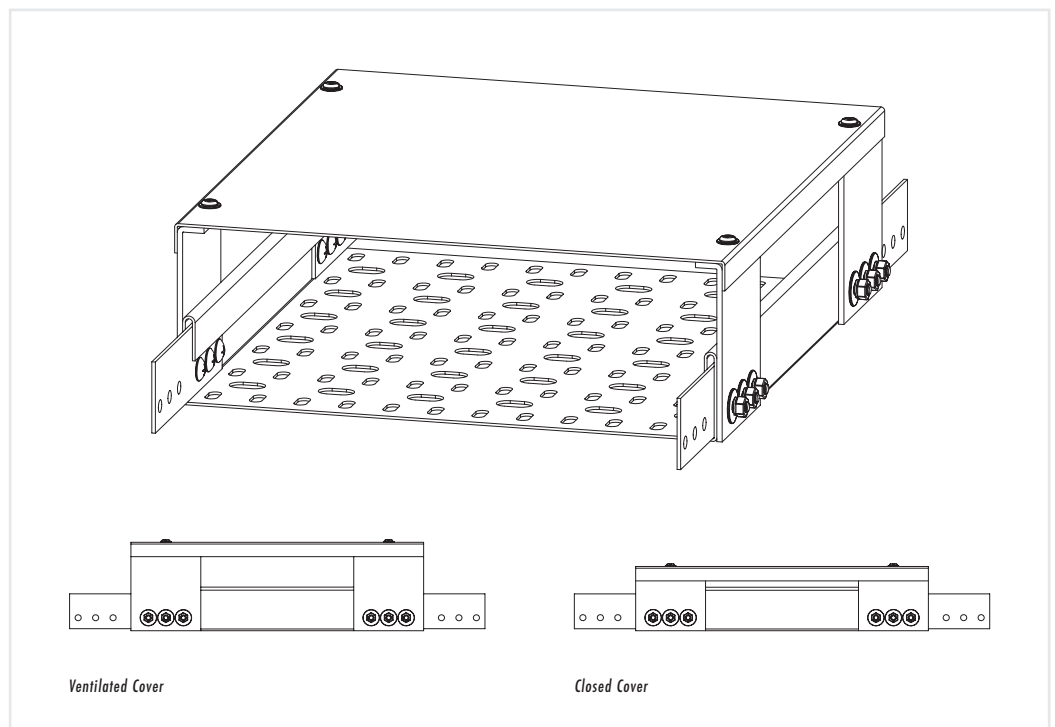

Fixing Method of Tray Cover



Cable Ladder

電纜梯架

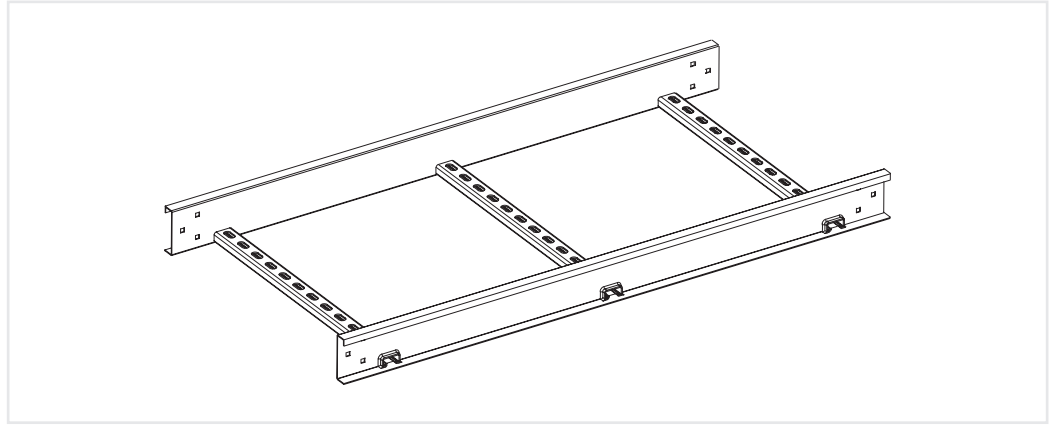

Technical Specification:

- BS EN61537 or IEC61537 to class 5
- Each length supplied with coupler, tinned earth link and fixing screws.
- Standard length is 2.44m/ Non standard thickness and finishes available to clients order.
- Customize size is available for order upon request.

Thickness of side member:

- 1.5mm for KTCL50 or 2.0mm for KTCL100, KTCL150

Size of slotted hole for rung:

- 30 x 15mm or special for client order

Span of rung:

- 150mm for top, end & 300mm center

Fixed method of side member & rung:

- Welding for mild steel & stainless steel
- Crimp for aluminum alloy.

Materials Standard:

- Galvanized Steel Sheet to BS4678
- Part 1: Class 3 Protection to BS EN10143 (Coating Mass 275g/m²)
- Standard product code +/GI

- Mild Steel Sheet to BS1449-1 or BS EN 10149-1 finished in Hot-dipped Galvanized after Perforation to ISO1461
- Standard product code +/HDG

- Stainless Steel to Grade 304 or Grade 316
- Standard product code +/SS304 or +/SS316

Other Material or Coating:

- Aluminum Steel Sheet
- Plastic Coated
- Epoxy / Polyester Powder Coated

Duty	Thk. (mm)	Side Member	Rung	Material
Light Duty				
KTCL 50	1.5			HDG GI EPC PC SS304 SS316
Heavy Duty				
KTCL 100	2.0			HDG GI EPC PC SS304 SS316
Extra Heavy Duty				
KTCL 150	2.0			HDG GI EPC PC SS304 SS316

Standard Product Code, i.e.:

300 x 100mm cable ladder 2.44m, hot-dipped galvanized after perforation = KTCL100/300/HDG

300 x 100mm cable ladder 90degree bend, hot-dipped galvanized after perforation

= KTCL100.B/300/90°

Ladder Width (mm):

100, 150, 200, 250, 300, 350, 400, 450, 500, 550, 600, 650, 700, 750, 800, 850, 900, 1000, 1050, 1100, 1150, 1200

H

Ladder Accessories 梯架配件

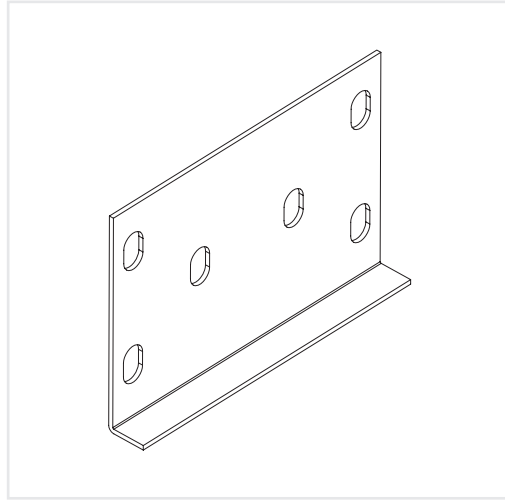

../SC Straight Coupler
KTCL 50
KTCL 100 /150

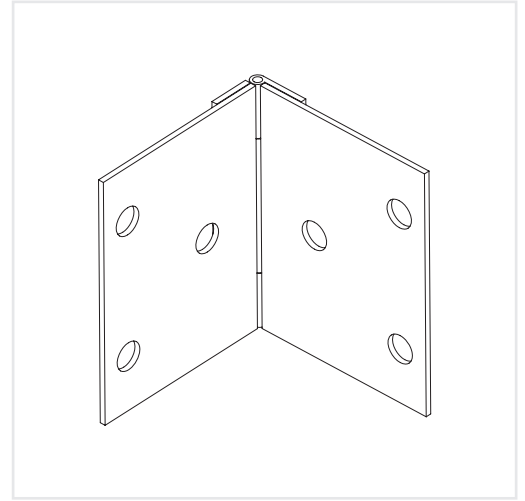

../HC Horizontal Hinged Coupler
KTCL 50
KTCL 100 / 150

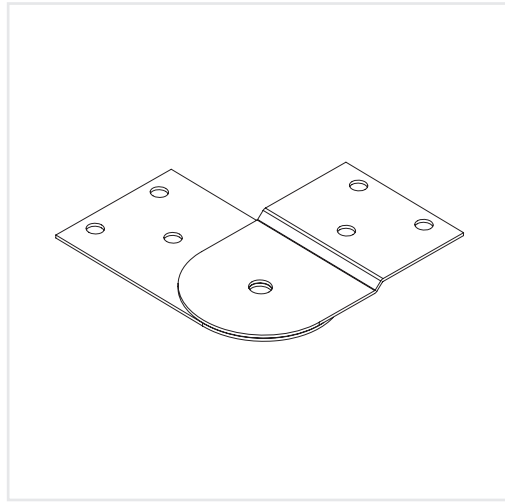

../VC Vertical Hinged Coupler
KTCL 50
KTCL 100/ 150

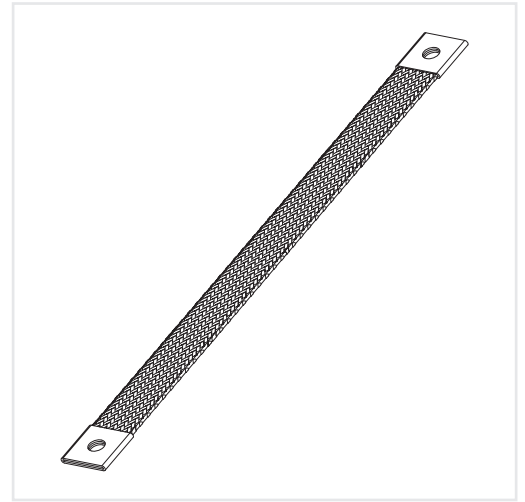

Earth Braid
KTEB

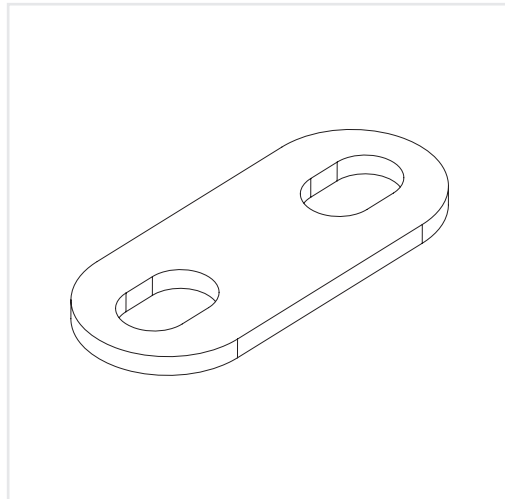

Copper Earth Link
KTCL

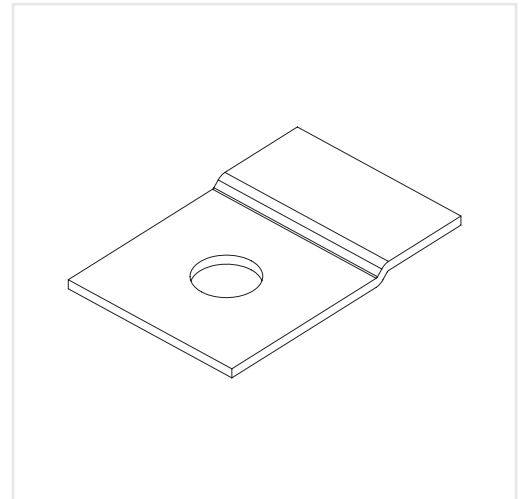

Ladder Clip
KTCLC
**M10 Fixing is required*



Cable
Ladder
Fitting
電纜梯架配件

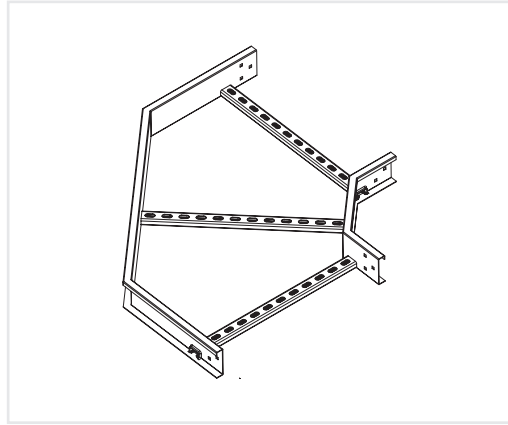

90° Bend
KCTL 50 / 100 / 150 . B / Width / 90°

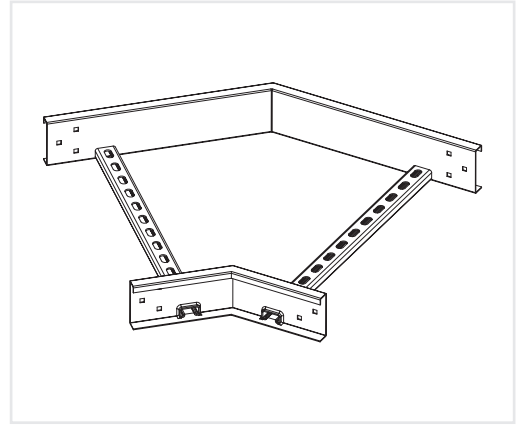

45° Bend
KCTL 50 / 100 / 150 . B / Width / 45°

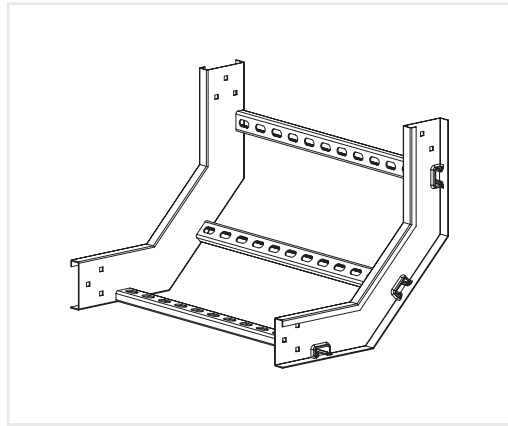

90° Internal Riser
KCTL 50 / 100 / 150 . IR / Width / 90°

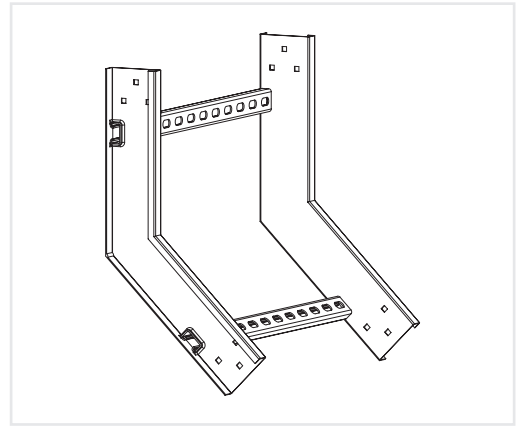

45° Internal Riser
KCTL 50 / 100 / 150 . IR / Width / 45°

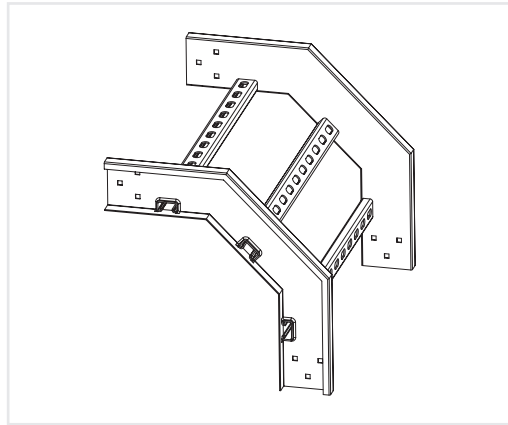

90° External Riser
KCTL 50 / 100 / 150 . ER / Width / 90°

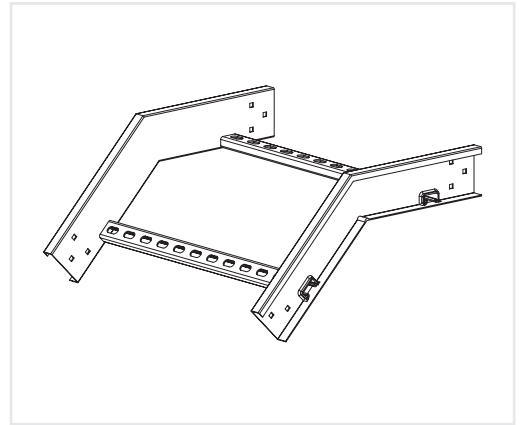

45° External Riser
KCTL 50 / 100 / 150 . ER / Width / 45°

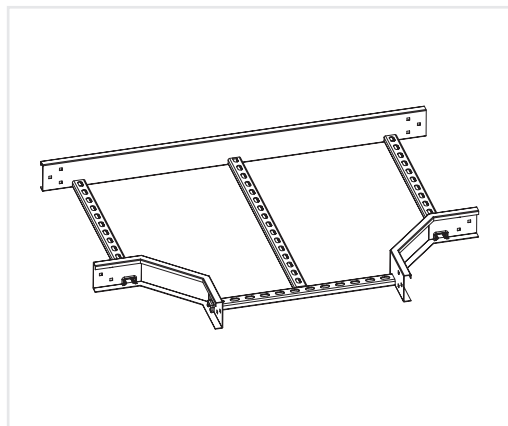

Equal Tee
KCTL L50 / 100 / 150 . T / Width

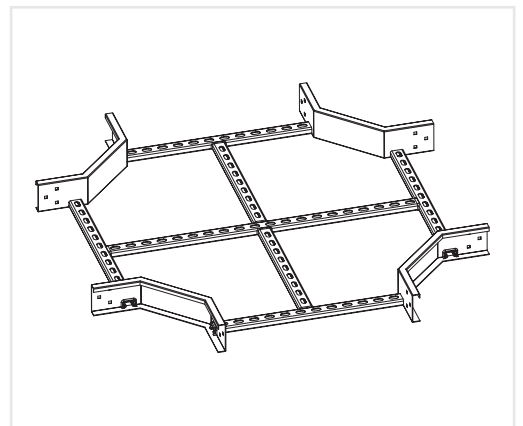

Crossover
KCTL 50 / 100 / 150 . X / Width



**Cable
Ladder
Fitting**
電纜梯架配件

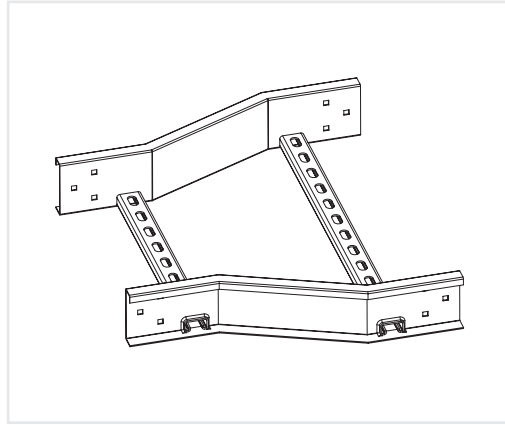

Centre Reducer
KCTL 50 / 100 / 150 . CR / Width

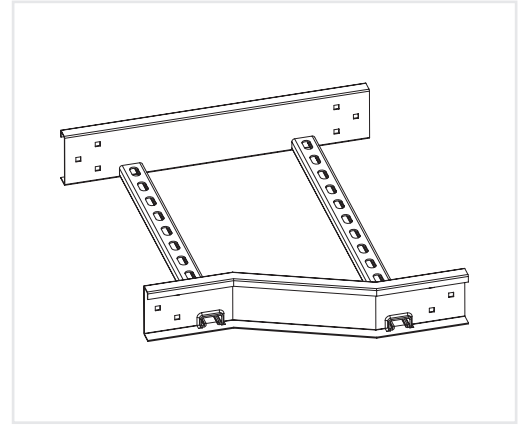

Right Hand Offset Reducer
KCTL 50 / 100 / 150 . RHR / Width

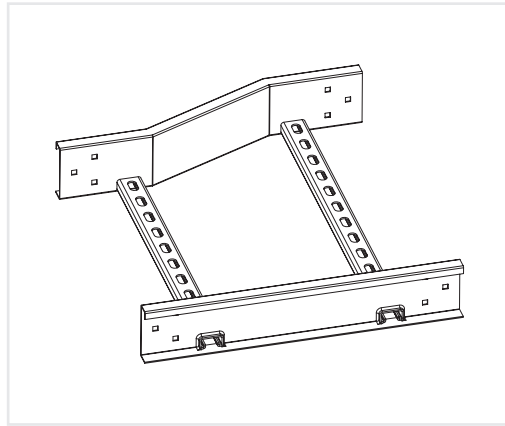

Left hand Offset Reducer
KCTL L50 / 100 / 150 . LHR / Width

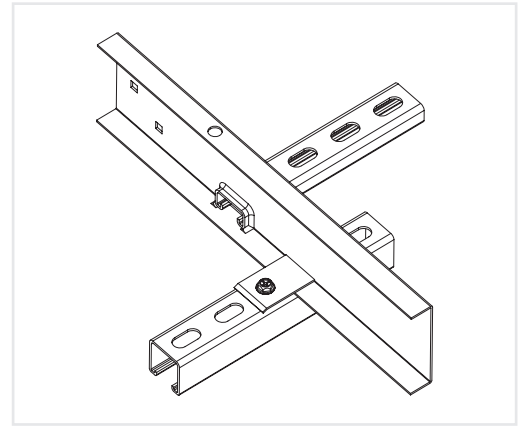

Hold Down Clip
KCTL 50 / 100 / 150 . HDC / Width

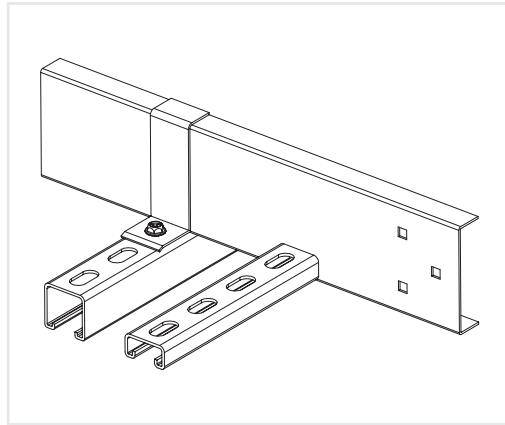

Hold Down Bracket
KCTL 50 / 100 / 150 . HBD / Width

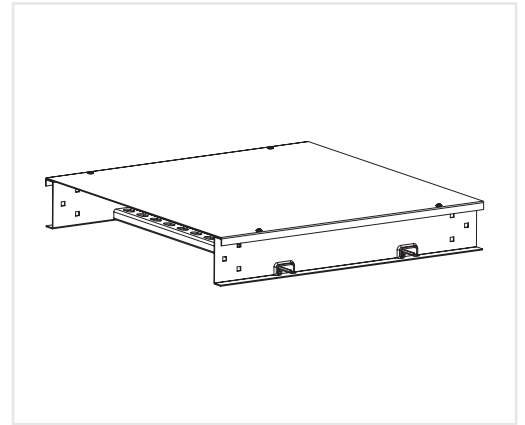

Close Cover
KCTL L50 / 100 / 150 . CC / Width

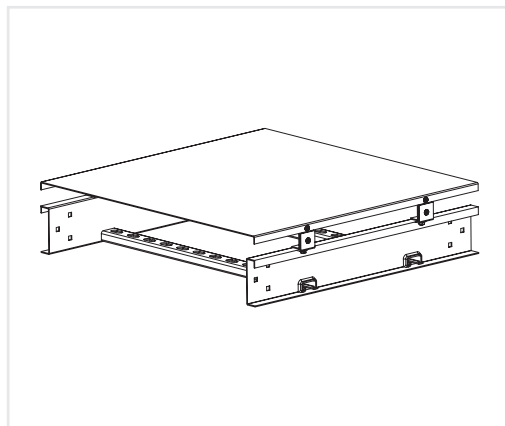

Ventilated Cover
KCTL 50 / 100 / 150 . VC / Width



U-Channels 承托骨架

This is a kind of universal strut system, allowing assembly of a wide variety of configurations quickly and easily. Plain, slotted, double or other combination of channels provide suitable configurations for different load and application requirements. The system is fully adjustable and reusable by a versatile range of fittings and accessories. Whilst the framing system is assembled, they will provide similar strength as welding connections. This system is designed for multi-purpose application without hot works.

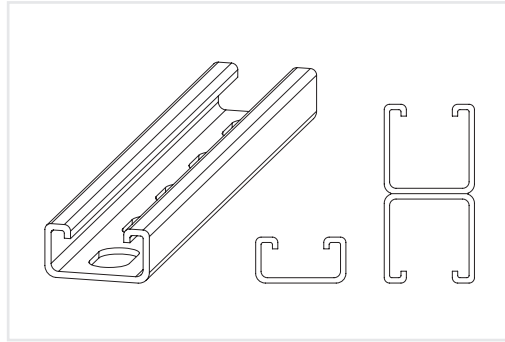

Channels

Manufactured from high quality mild steel, pre-galvanized steel or stainless steel comply to BS 6946 standard.

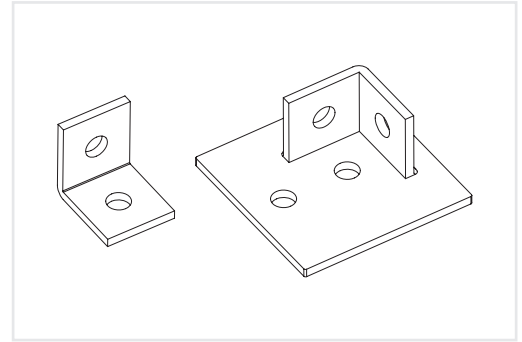

Fittings

Manufactured from steel bar comply to BS EN 10277 and shall be zinc plate to BS 7371-12, stainless steel 304 / 316 or hot-dipped galvanized to ISO 1461 finished available to order.

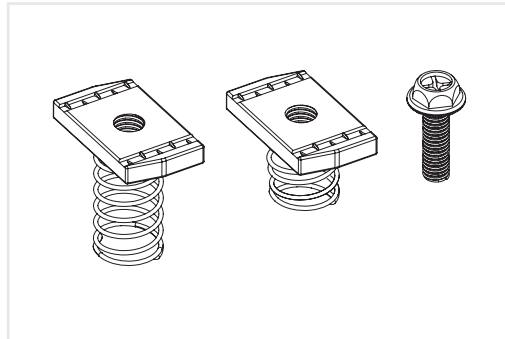

Long / short spring nut & hex head screw (G8.8)

Manufactured from steel bar comply to BS EN 10277 and shall be zinc plate to BS 7371-12 or stainless steel 304 / 316 Available threaded size M6 / M8 / M10 / M12 / M16

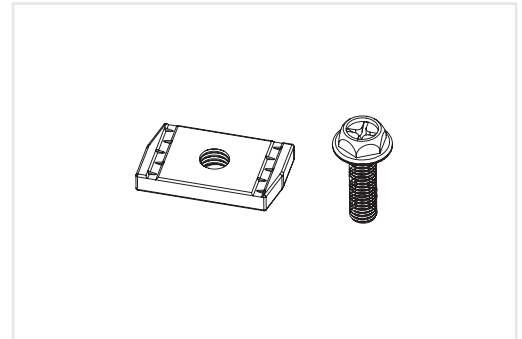

Channel nut w/o spring & hex head screw (G8.8)



Application Method

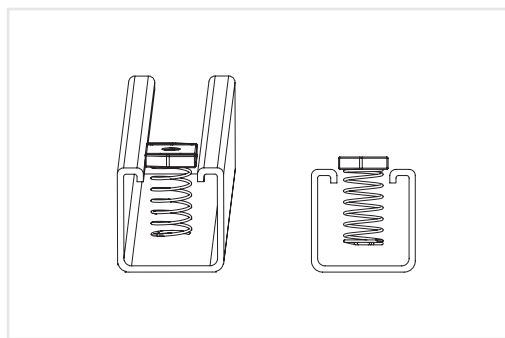

1. Insert channel nut anywhere along the continuous channel slots. Spring holds back nut in place.

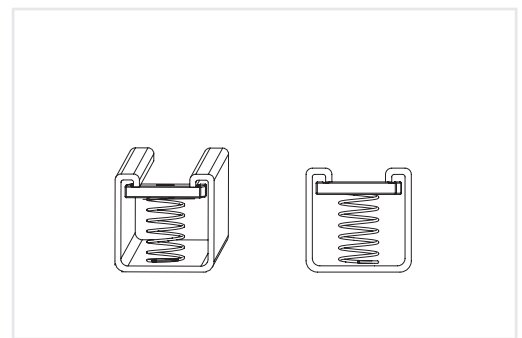

2. A 90° twist to allow serrated edge of the channel nut to grip in-turned lips of the channel.

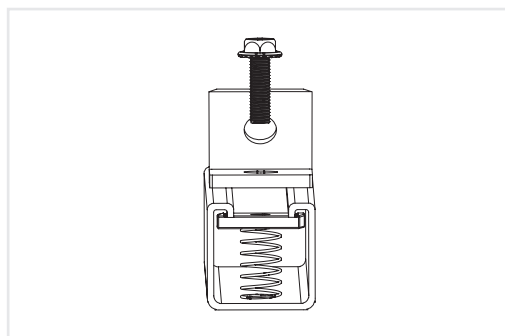

3. Place appropriate fitting over channel nut and insert bolt for connection.

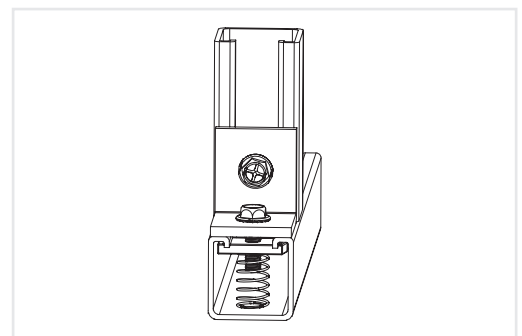

4. To tighten bolt with wrench for complete assembly.



U-Channels

承托骨架

Part No.	Type	X – X Axis			Y – Y Axis			Weight kgs/M	Area CM ²
		Icm ⁴	Zcm ³	Rcm	Icm ⁴	Zcm ³	Rcm		
UC 4121	Plain	1.20	0.99	0.72	5.45	2.65	1.51	1.81	2.30
UC 4121S	Slotted	0.99	0.90	0.70	5.30	2.56	1.62	1.60	1.96

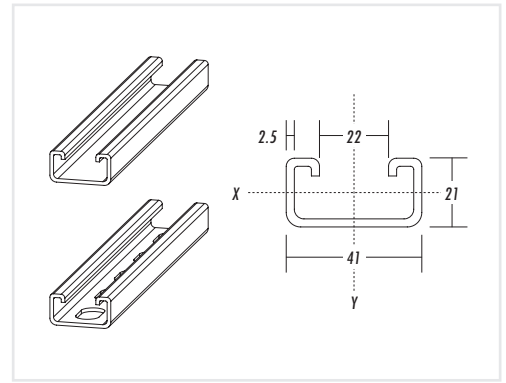

Part No.	Type	X – X Axis			Y – Y Axis			Weight kgs/M	Area CM ²
		Icm ⁴	Zcm ³	Rcm	Icm ⁴	Zcm ³	Rcm		
UCD 4121	Plain	5.68	3.13	1.13	10.74	5.20	1.55	3.62	4.46

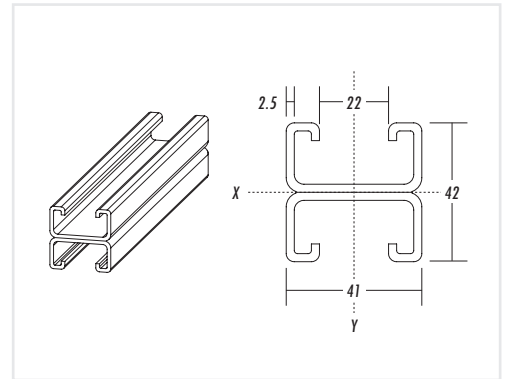

Part No.	Type	X – X Axis			Y – Y Axis			Weight kgs/M	Area CM ²
		Icm ⁴	Zcm ³	Rcm	Icm ⁴	Zcm ³	Rcm		
UC 4141	Plain	7.36	3.15	1.48	9.28	4.5	1.65	2.66	3.30
UC 4141S	Slotted	6.15	2.92	1.43	9.25	4.46	1.74	2.50	3.00

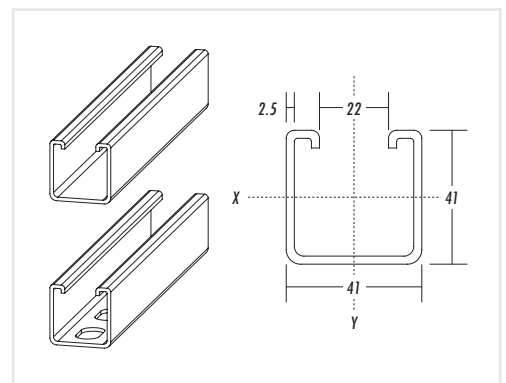

Part No.	Type	X – X Axis			Y – Y Axis			Weight kgs/M	Area CM ²
		Icm ⁴	Zcm ³	Rcm	Icm ⁴	Zcm ³	Rcm		
UCD 4141	Plain	36.30	8.85	2.33	18.52	8.96	1.66	5.30	6.60

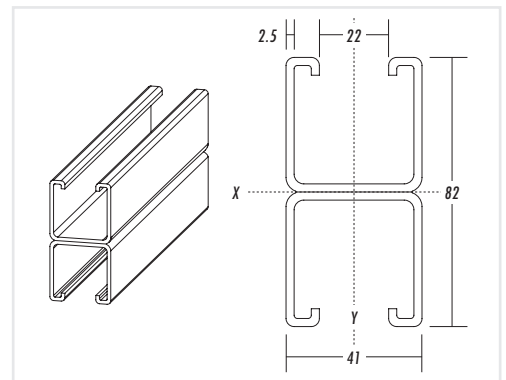

All U-channels supplied in standard length 3 meter. Special length is also available upon customer request.

Materials Standard:

- Galvanized Steel Sheet to BS4678
Part 1: Class 3 Protection to BS EN10143(Coating Mass 275g/m²)
- Mild Steel Sheet to BS1449-1 or BS EN 10149-1 finished in Hot-dipped Galvanized after Perforation to ISO1461
- Stainless Steel to Grade 304 or Grade 316
- Other Material or Coating:
 - Aluminum Steel Sheet
 - Plastic Coated
 - Epoxy / Polyester Powder Coated

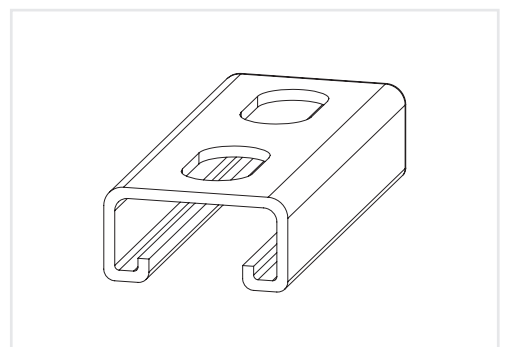
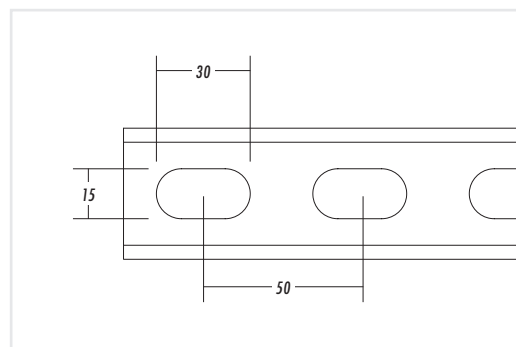

Standard slot size: 30mm x 15mm x 50mm pitch



U-Channels Fittings 承托骨架配件

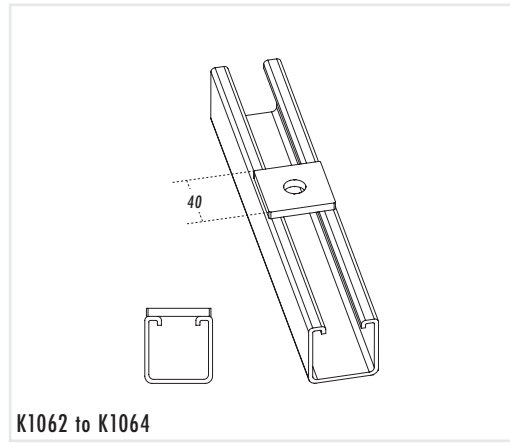

K1062 to K1064

	Hole Size (mm)	Thread Size (mm)	Weight Each (mm)
1062	8	6	72
1062/A	10	8	71
1063	12	10	70
1064	14	12	68

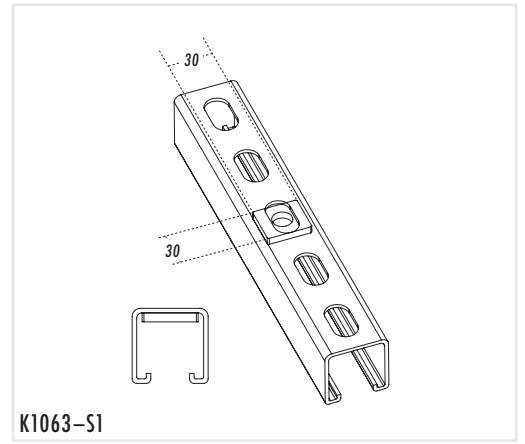

K1063-S1

	Hole Size (mm)	Thread Size (mm)	Weight Each (mm)
1063-S1/06	8	6	72
1063-S1/08	10	8	71
1063-S1/10	12	10	70
1063-S1/12	14	12	68

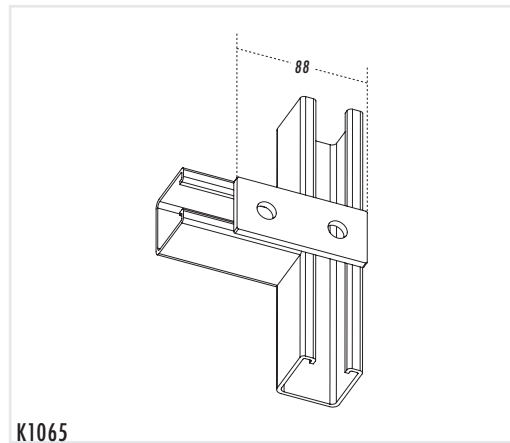

K1065

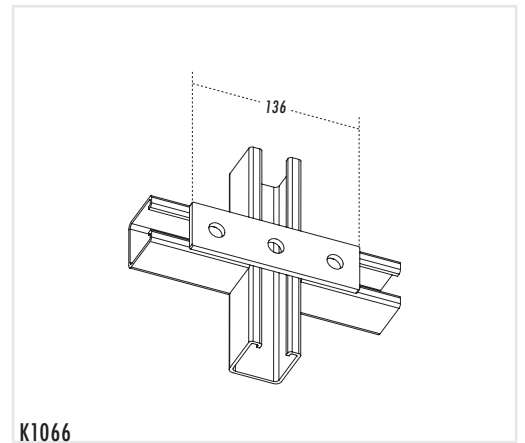

K1066

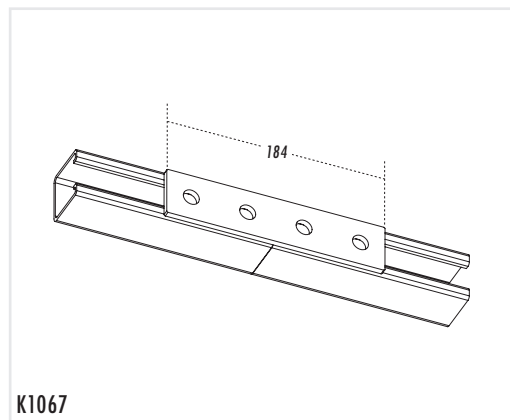

K1067

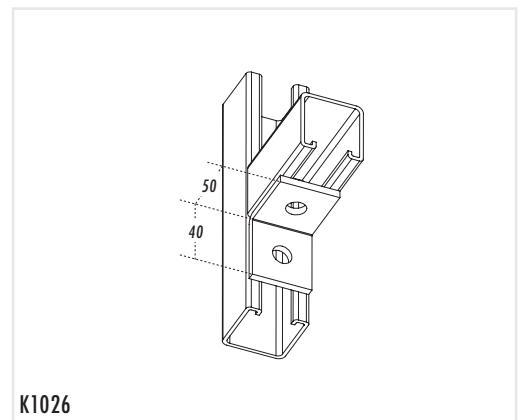

K1026

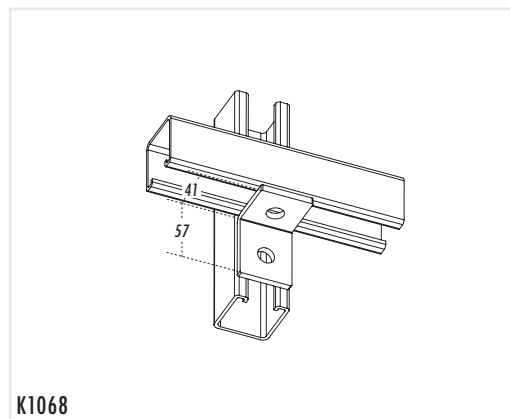

K1068

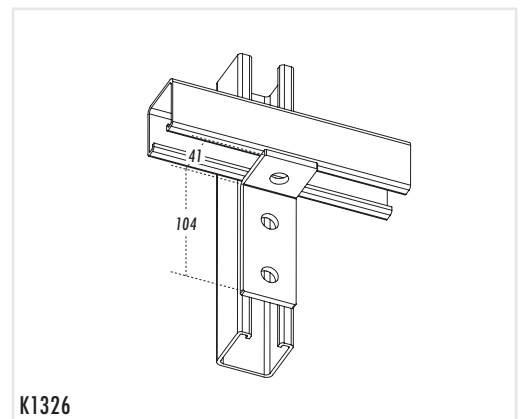

K1326

Fitting specification (unless noted):

Holes : 13mm diameter

Hole spacing : 20mm from end and 48mm on center;

Width : 40mm;

Thickness 5mm (Order hardware separately)

Standard Finishes: GI / HDG / SS304 / SS316 / EP / PC



U-Channels Fittings 承托骨架配件

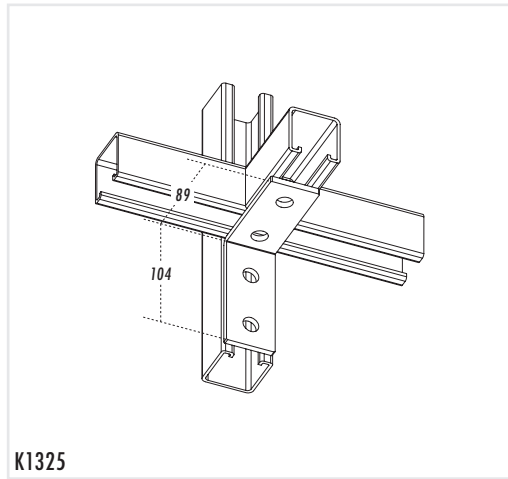

K1325

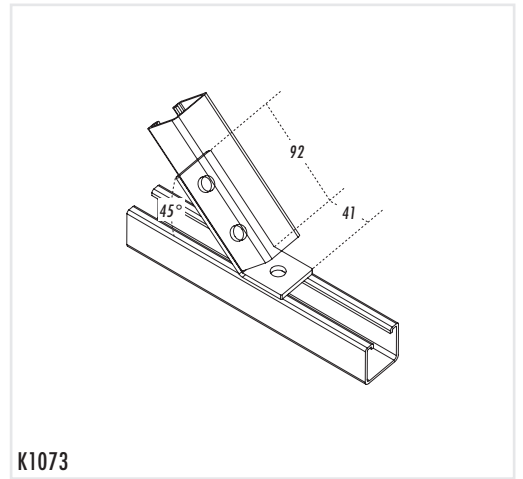

K1073

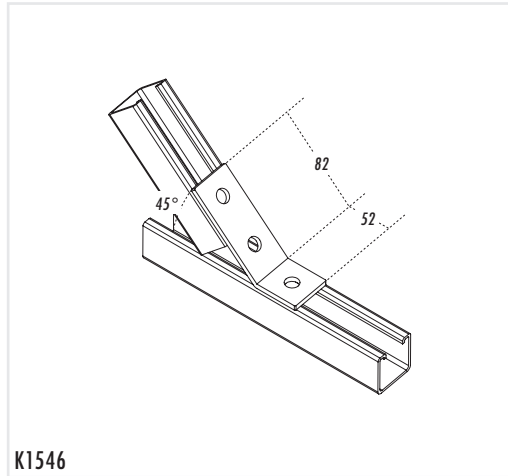

K1546

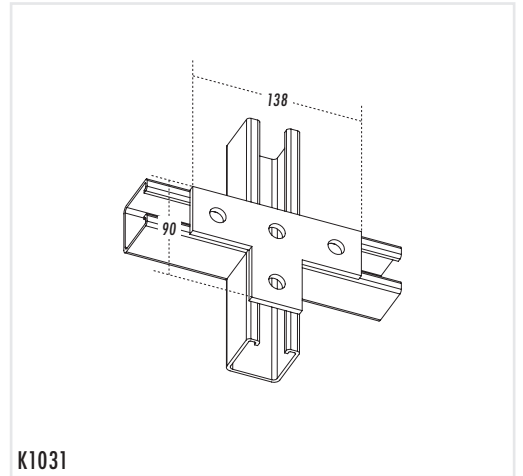

K1031

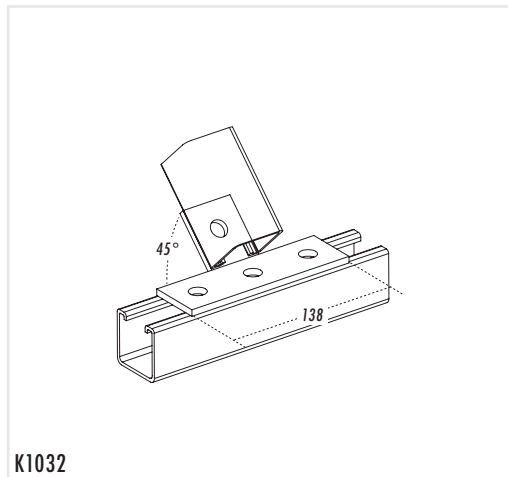

K1032

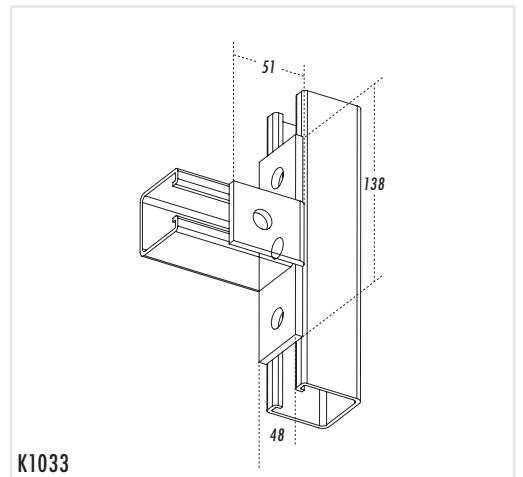

K1033

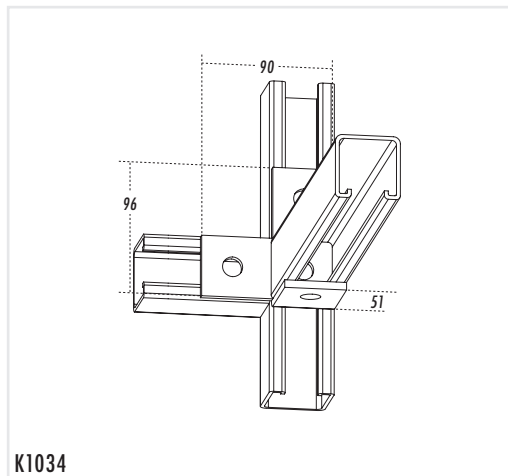

K1034

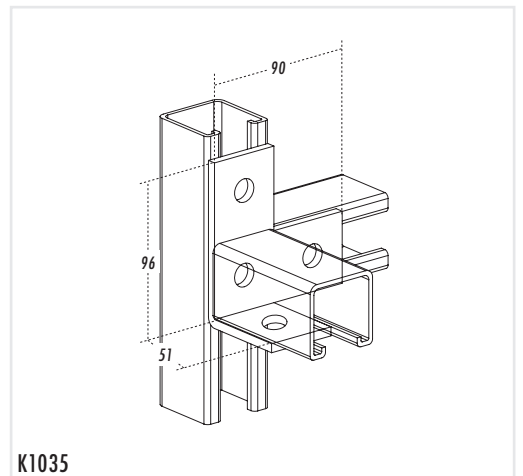

K1035

Fitting specification (unless noted):

Holes : 13mm diameter

Hole spacing : 20mm from end and 48mm on center;

Width : 40mm;

Thickness 5mm (Order hardware separately)

Standard Finishes: GI / HDG / SS304 /

SS316 / EP / PC



U-Channels Fittings 承托骨架配件

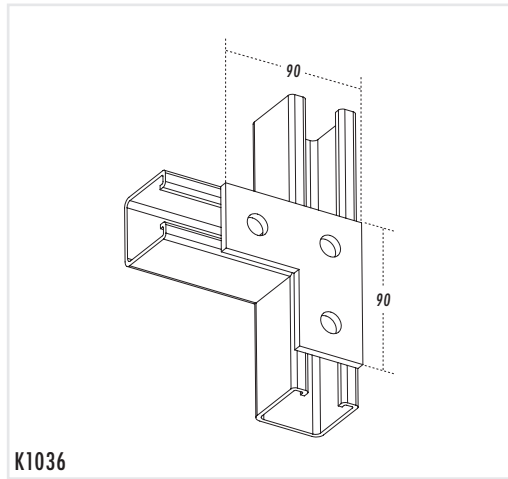

K1036

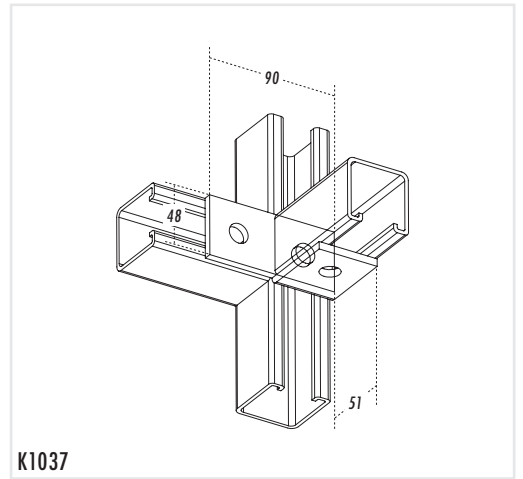

K1037

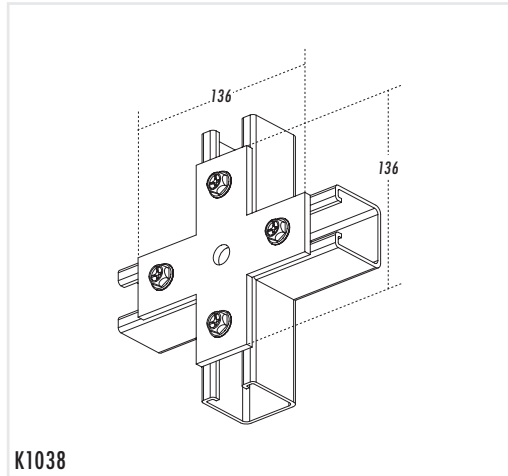

K1038

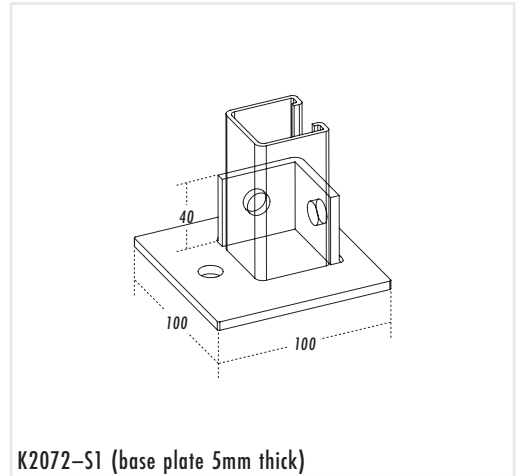

K2072-S1 (base plate 5mm thick)

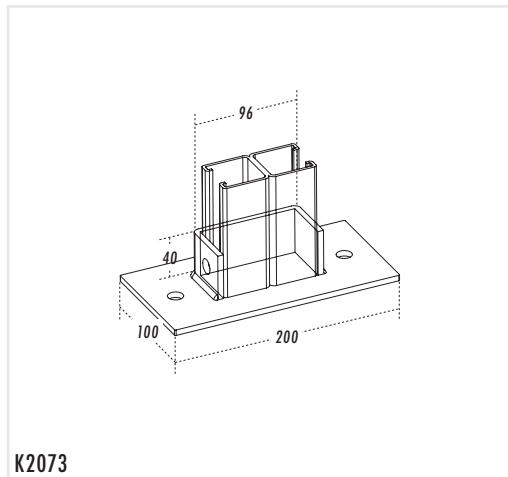

K2073

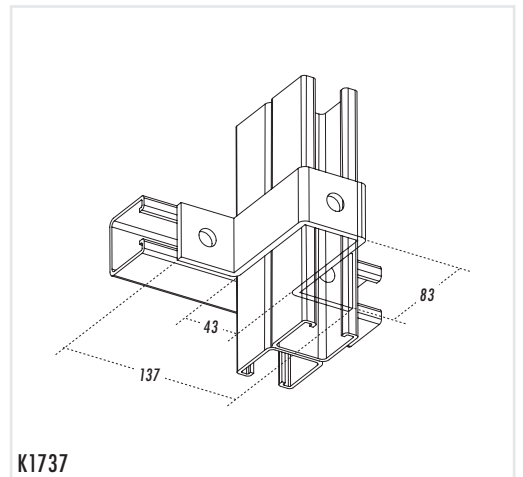

K1737

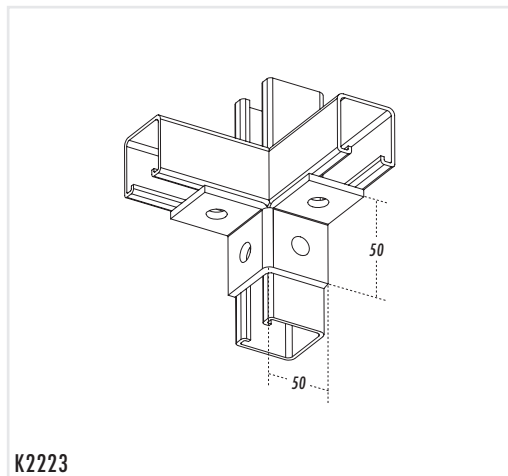

K2223

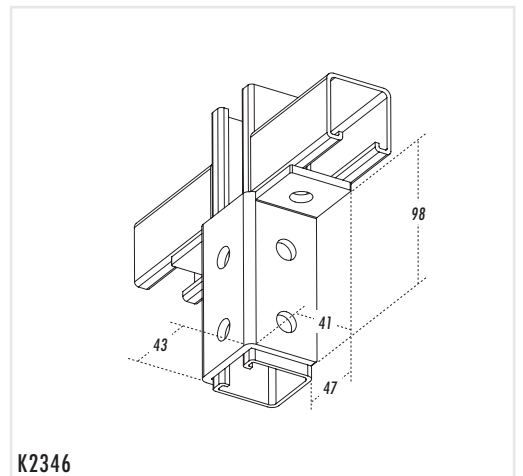

K2346

Fitting specification (unless noted):

Holes : 13mm diameter

Hole spacing : 20mm from end and 48mm on center;

Width : 40mm;

Thickness 5mm (Order hardware separately)

Standard Finishes: GI / HDG / SS304 /

SS316 / EP / PC



U-Channels Fittings 承托骨架配件

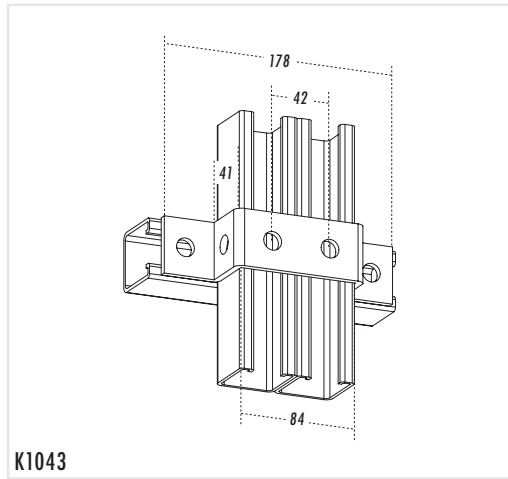

K1043

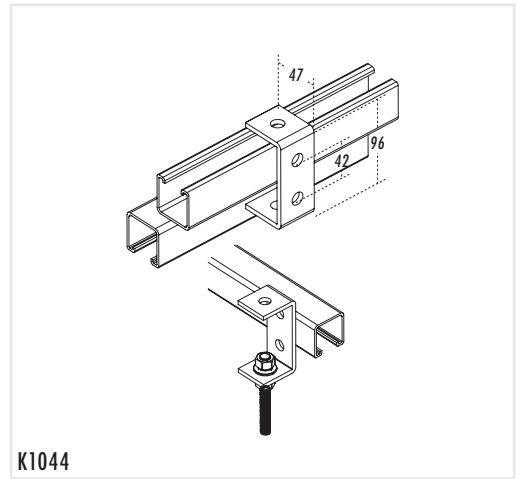

K1044

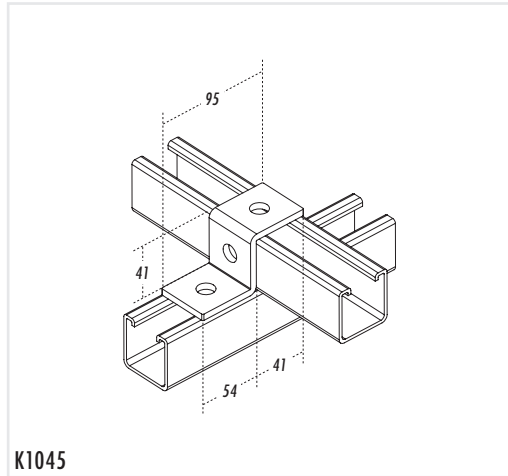

K1045

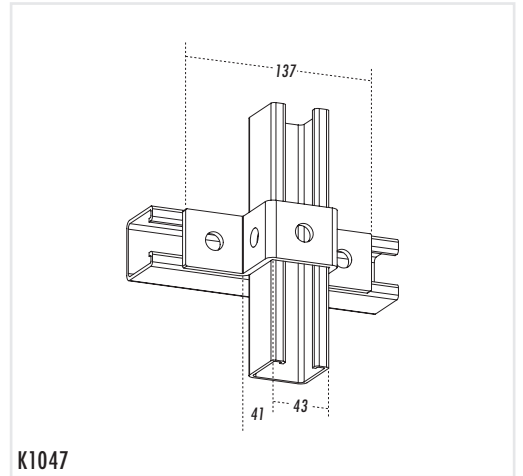

K1047

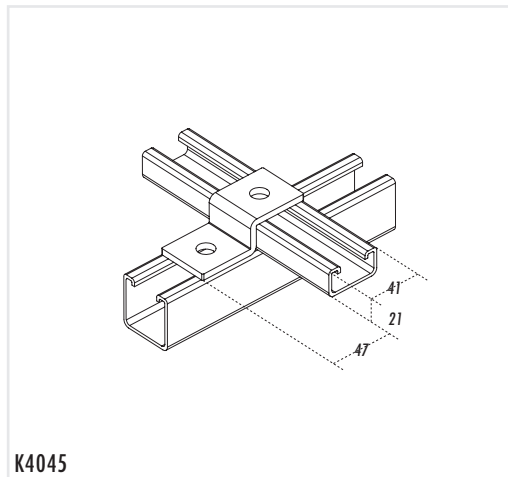

K4045

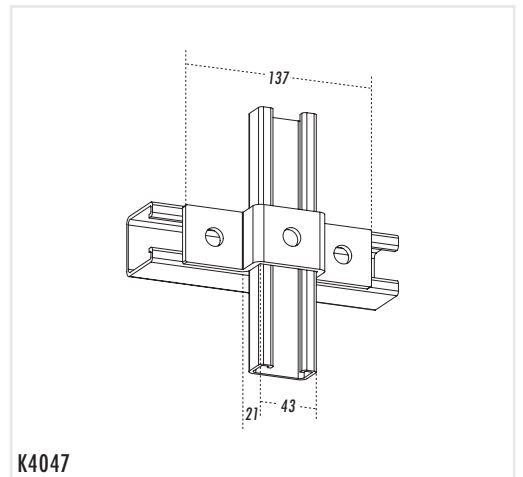

K4047

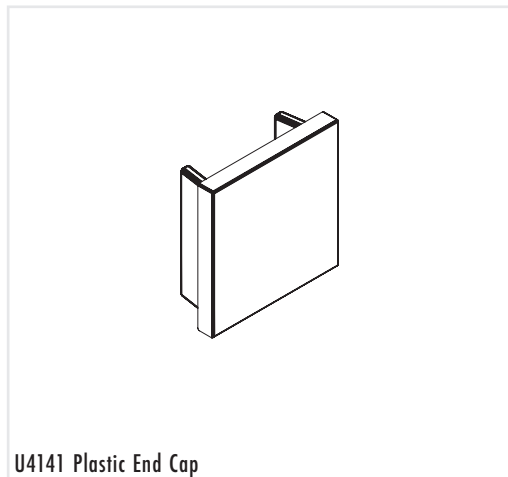

U4141 Plastic End Cap

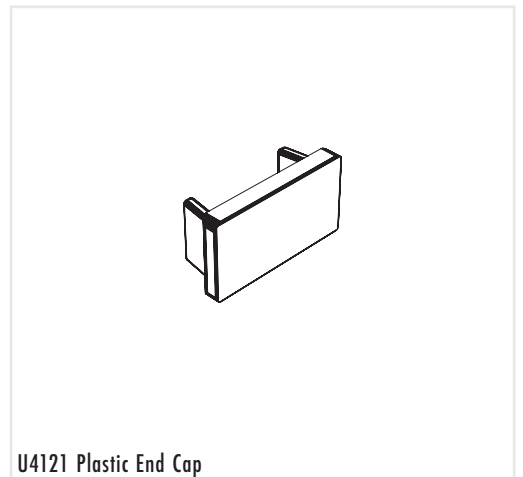

U4121 Plastic End Cap

* U4141 is manufactured from PVC and finished in white color, for use with UC4141 and UC4141S channel.

** U4121 is manufactured from PVC and finished in white color, for use with UC4121 and UC4121S channel.



U-Channels Fittings 承托骨架配件

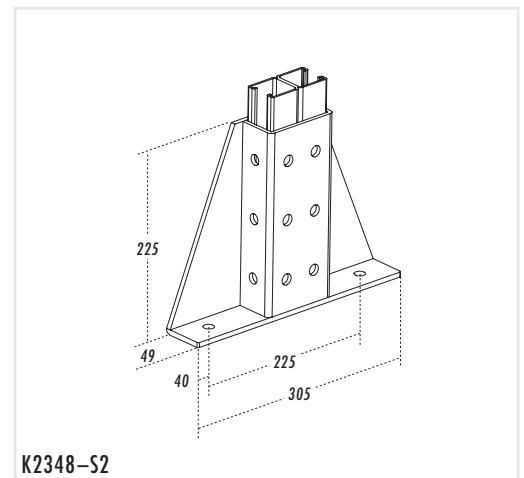
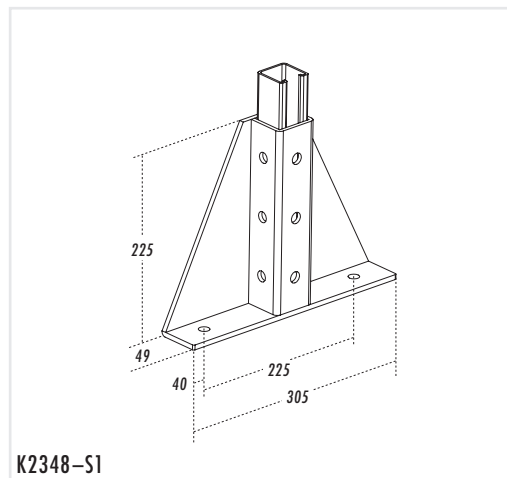
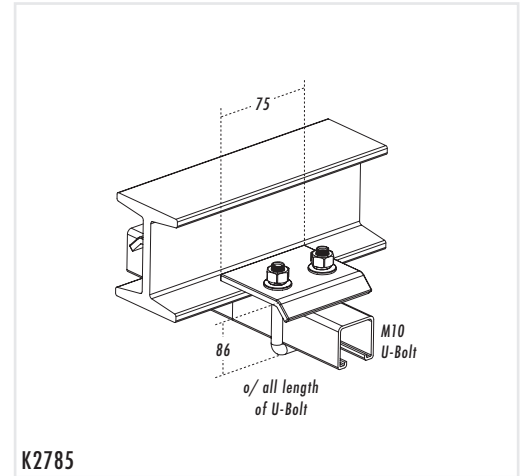
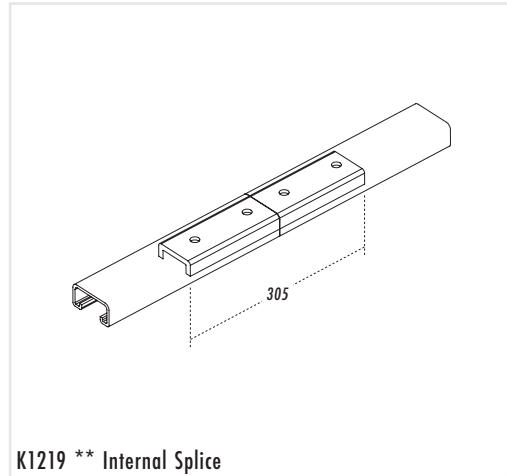
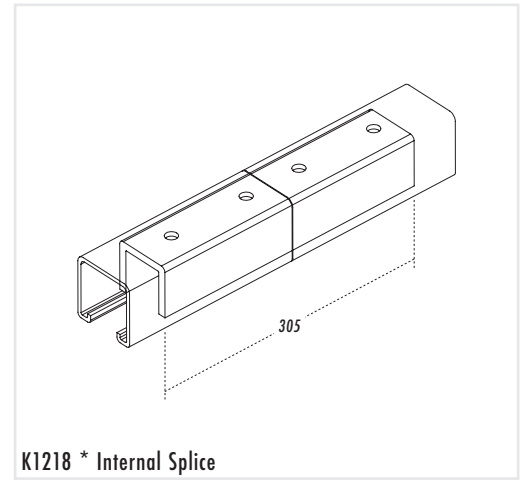
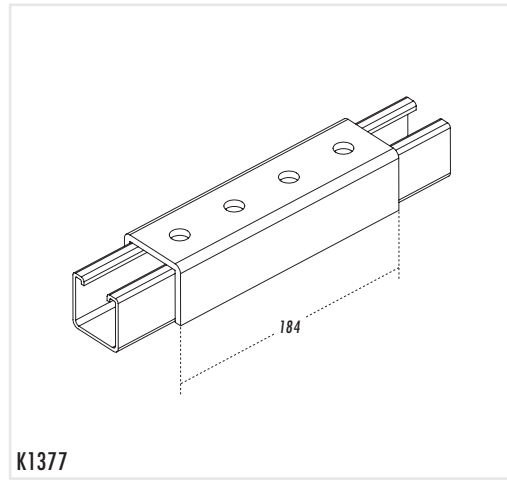

* K1218 for use with UC4141, and UCD4141 channel.
N.B.4 No. M6 Pan head fixing screws are included.

** K1219 for use with UC4121, and UCD4121 channel.
N.B.4 No. M6 Pan head fixing screws are included.



Concrete Inserts 混凝土嵌件

Concrete Inserts have the same general specifications as the similar single channel sections but are provided with anchor lugs spaced along their reverses side. They are supplied ready packed with polystyrene foam to avoid concrete entering the channel during pouring. The standard length is 6.0M.

Inserts should be fixed to the wooden shuttering by nailing through the foam filling (in the cut-out holes) and the concrete is then poured. When the shuttering is removed and the foam pulled out, each insert presents an open channel face, flush with the surface of the concrete and capable of accepting the range of brackets.

The following data is based upon tests carried out on inserts set into vibrated mix concrete blocks, maximum aggregate size 20mm, with a crushing strength of 30 N/mm² after 28 days.

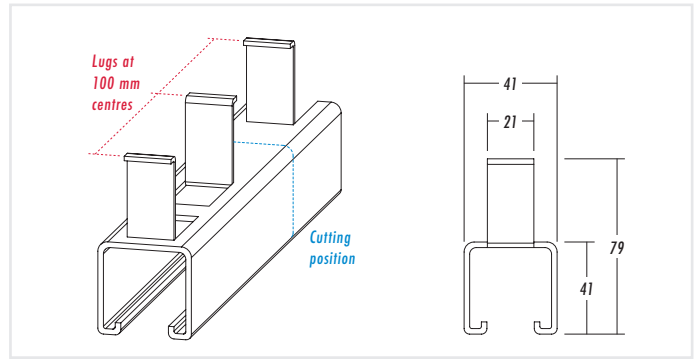

K3270

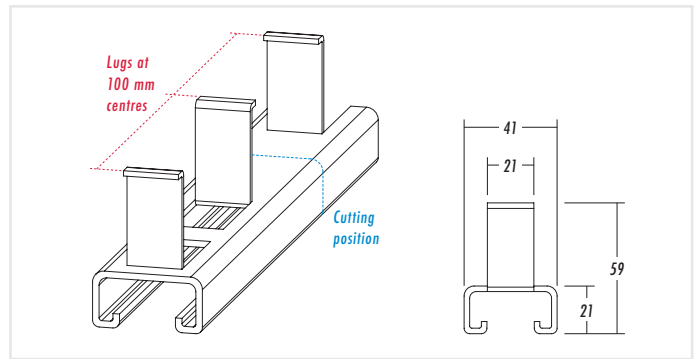

K3370

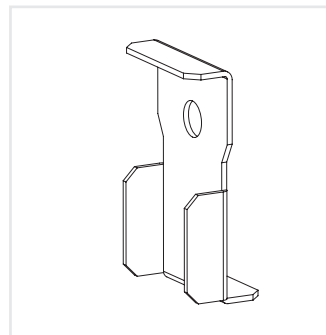

End Cap K3270/E

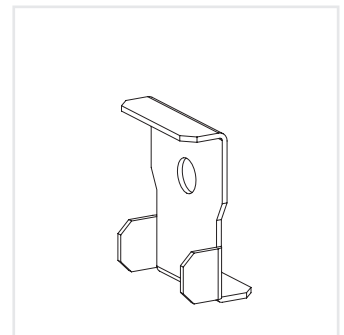

End Cap K3370/E

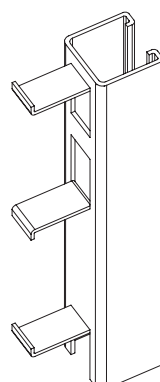
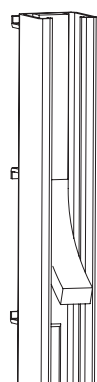
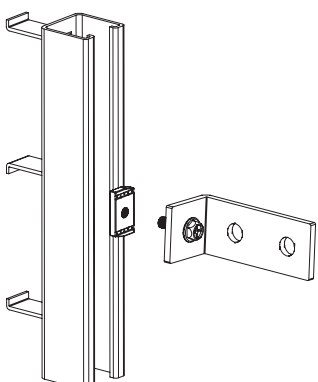
		
<p>Easy placing The Concrete Insert is firmly fixed to the concrete side of shuttering before pouring.</p>	<p>Immediate use When the shuttering is struck, the insert is ready to use.</p>	<p>Fixing at any point Brackets and other components can be attached at any point along the Unistrut continuous entry channel.</p>

The Benefits



Cantilever Arms 懸臂配件

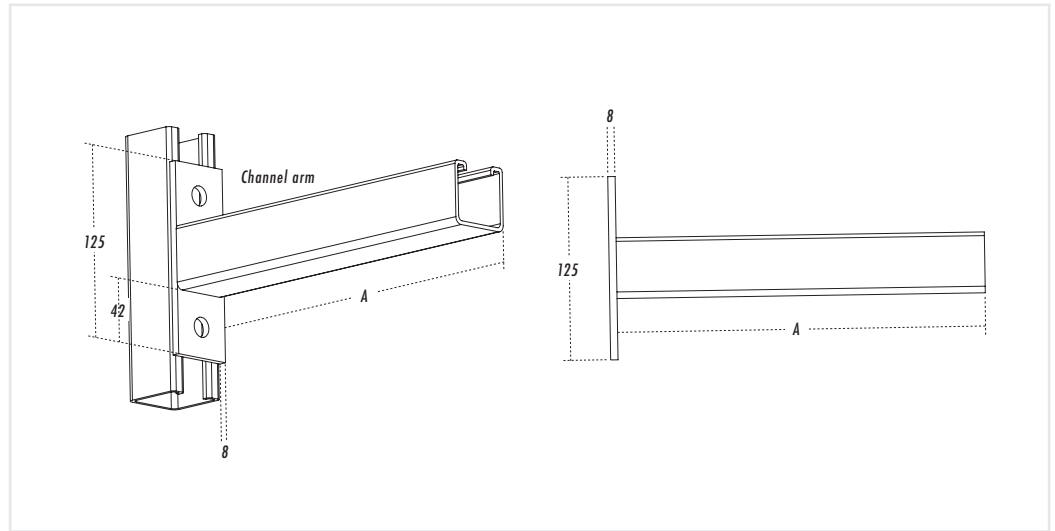

K2663

Part No.	A mm	Recommended UDL kgf for vertical channel UC 4141	Weight each kg
K2663 / 150	150	680	0.80
K2663 / 300	300	356	1.17
K2663 / 450	450	240	1.59
K2663 / 600	600	181	2.03
K2663 / 750	750	143	2.53

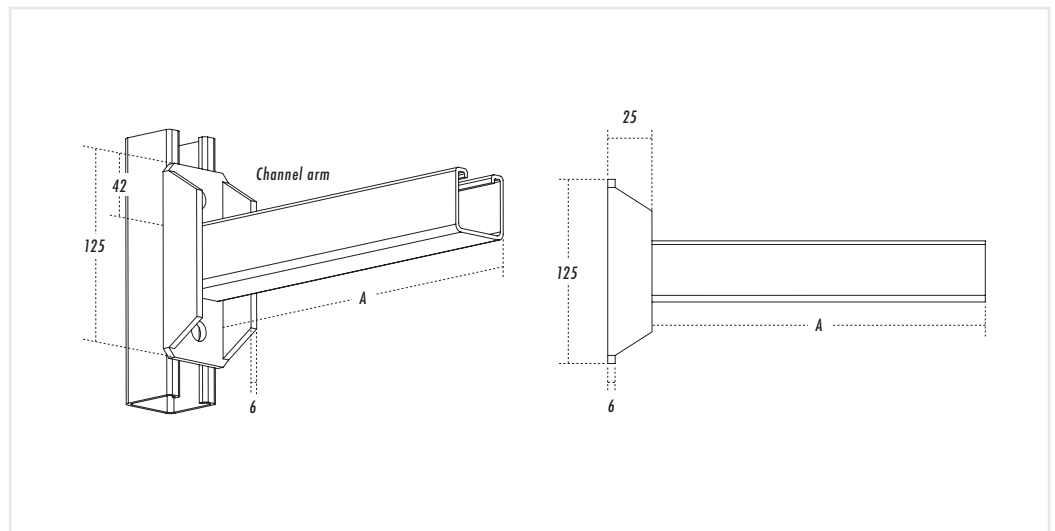

K2664

Part No.	A mm	Recommended UDL kgf for vertical channel UC 4141	Weight each kg
K2664 / 150	150	680	0.91
K2664 / 300	300	475	1.40
K2664 / 450	450	300	1.69
K2664 / 600	600	225	2.23
K2664 / 750	750	180	2.58

Fitting specification (unless noted):

Holes : 13mm diameter

Hole spacing : 20mm from end and 48mm on center;

Width : 40mm;

Thickness 5mm (Order hardware separately)

Standard Finishes: GI / HDG / SS304 / SS316 / EP / PC



Cantilever Arms 懸臂配件

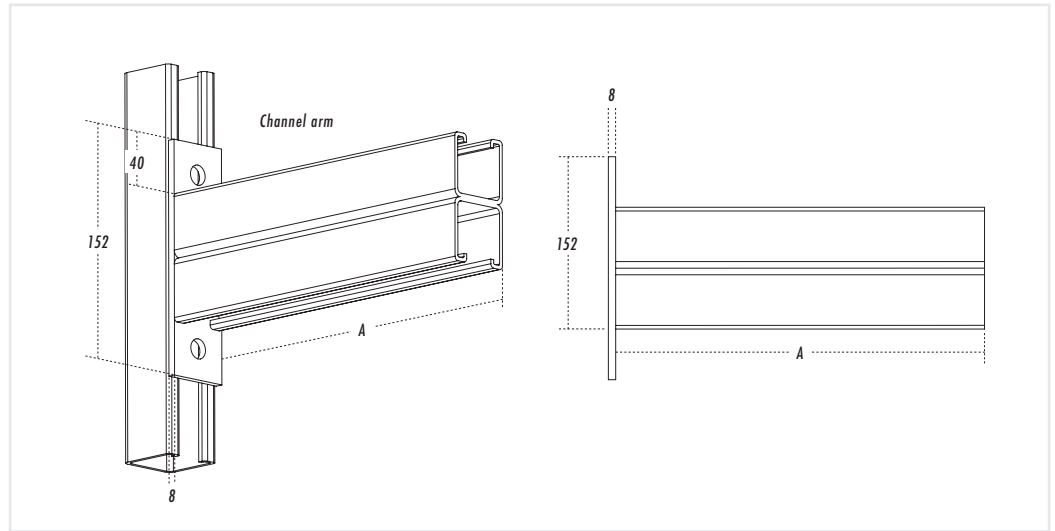

K2665

Part No.	A mm	Recommended UDL kgf for vertical channel UCD 4141	Weight each kg
K2665 / 300	300	609	2.13
K2665 / 450	450	410	2.31
K2665 / 600	600	309	3.72
K2665 / 750	750	248	4.66

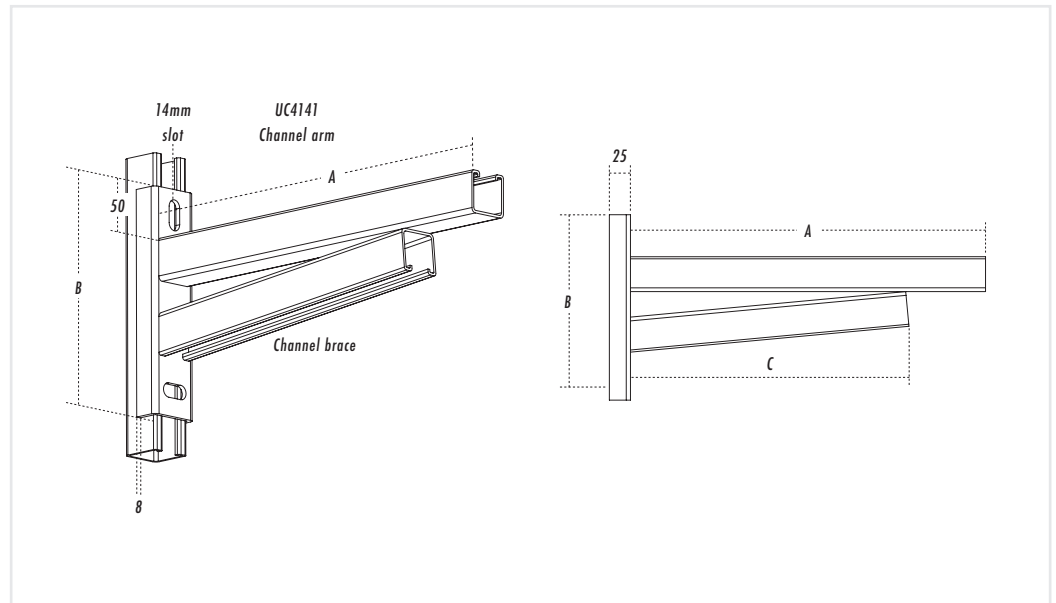

K2666

Part No.	A mm	B mm	C mm	Recommended UDL kgf for vertical channel UC 4141	Weight each kg
K2666 / 700	700	270	585	460	4.63
K2666 / 900	900	330	748	460	4.78
K2666 / 1050	1050	380	906	460	5.67

Fitting specification (unless noted):

Holes : 13mm diameter

Hole spacing : 20mm from end and 48mm on center;

Width : 40mm;

Thickness 5mm (Order hardware separately)

Standard Finishes: GI / HDG / SS304 /

SS316 / EP / PC



**Cable &
Pipe Clamps**
電線及管道夾碼

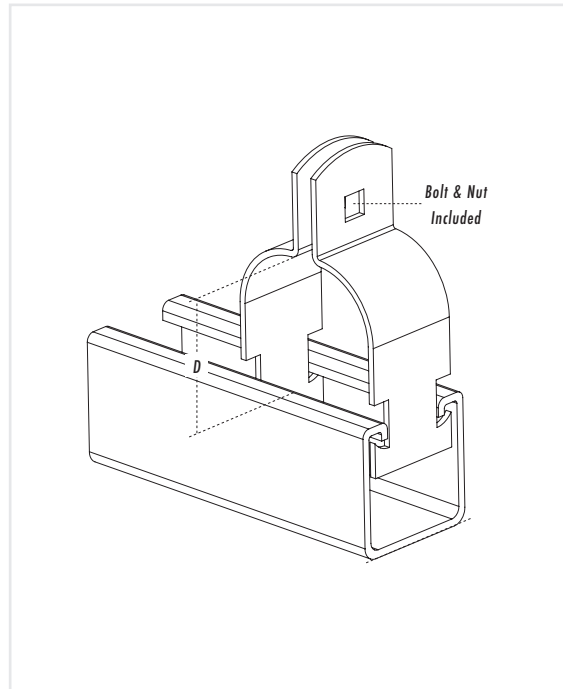

Clamp
Finish - ZP/HDG/SS304/SS316

Description	D
K2-21	21
K2-24	24
K2-27	27
K2-30	30
K2-35	35
K2-40	40
K2-44	44
K2-48	48
K2-52	52
K2-55	55
K2-60	60
K2-65	65
K2-73	73
K2-78	78
K2-85	85

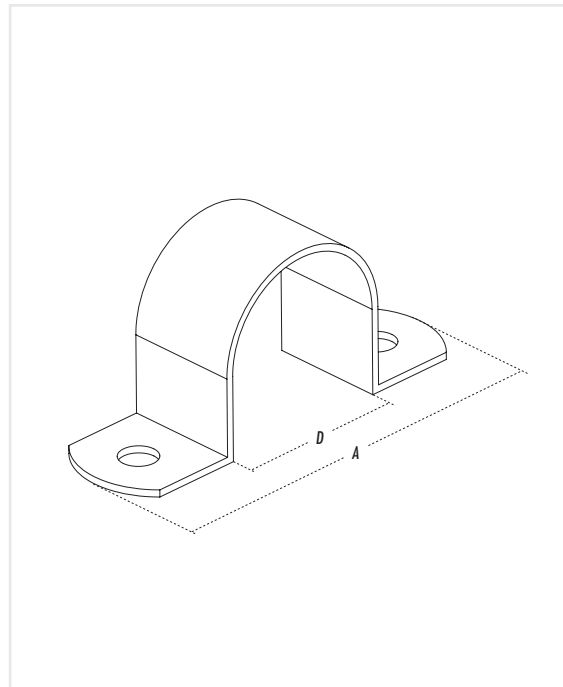

Clamp
Finish - HDG/SS304/SS316

Description	D	A
K3 - 19	19	75
K3 - 27	27	83
K3 - 34	34	90
K3 - 48	48	114
K3 - 60	60	126
K3 - 76	76	162
K3 - 89	89	175
K3 - 102	102	188
K3 - 114	114	200
K3 - 140	140	230
K3 - 152	152	242
K3 - 168	168	258
K3 - 203	203	293



**Cable &
Pipe Clamps**
電線及管道夾碼

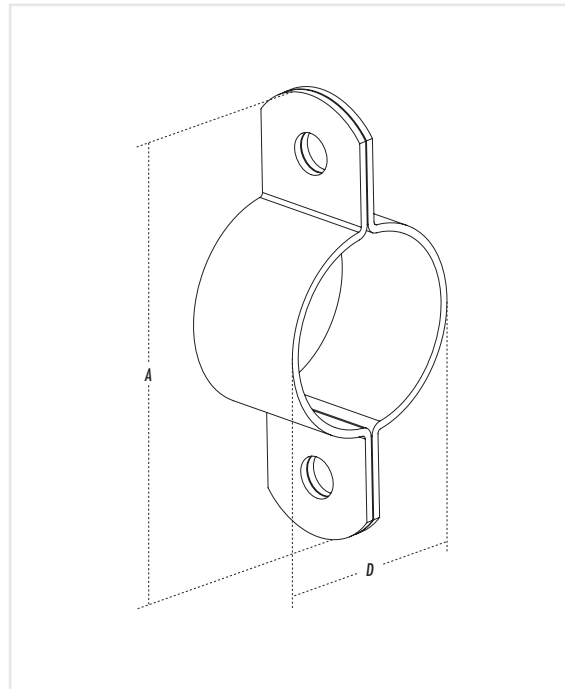

Hanger Clamp
Finish - HDG/SS304/SS316

Description	D	A
K4 - 19	19	75
K4 - 27	27	83
K4 - 34	34	90
K4 - 48	48	114
K4 - 60	60	126
K4 - 76	76	162
K4 - 88	88	172
K4 - 102	102	188
K4 - 114	114	200
K4 - 127	127	213
K4 - 140	140	230
K4 - 152	152	242
K4 - 168	168	258
K4 - 178	178	268
K4 - 203	203	293

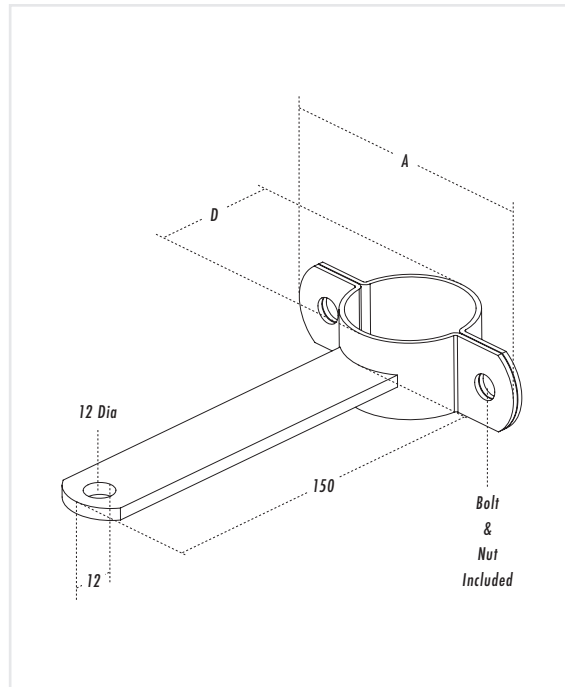

Hanger Clamp
Finish - HDG/SS304/SS316

Description	D	A
K5 - 19	19	75
K5 - 27	27	83
K5 - 34	34	90
K5 - 48	48	114
K5 - 60	60	126
K5 - 76	76	162
K5 - 89	89	175
K5 - 102	102	188
K5 - 114	114	200
K5 - 127	127	213
K5 - 140	140	230
K5 - 152	152	242
K5 - 168	168	258
K5 - 203	203	293



Finishes

Pre – Galvanized

Continuous hot dip zinc coated steel sheet to BS4678, part 1 class 3. The base material is flat rolled sheet in coils suitably treated and annealed then passed through bath of molten zinc. Minimum coating designation of G275 with a coating weight of 275 g/m² including both sides which equates to a zinc coating of 15.2 µm each side.

Hot Dip Galvanized (Post – Galvanized)

Hot dip galvanized is in accordance with BS729; 1971 or ISO 1460 / 1461. Details stated in the following table.

BS729: 1971 Material Thickness	Coating Weight (Minimum Average) g/m ²	Average Zinc Thickness (Microns)
5mm thick and over	610	85
Under 5mm but not less than 2mm	460	65
Under 2mm but not less than 1mm	335	47
Iron castings	610	85
Centrifuged for threaded fasteners	305	43

ISO 1460 / 1461

ISO1461 coating minimum masses (related to thickness) on sample which are not centrifuged.

Article and its Thickness mm	(a) Local coating (m/A) (minimum)		(b) Mean coating (m/A) (minimum)	
	g/m ²	µm	g/m ²	µm
Steel > 6mm	505	70	610	85
Steel > 3mm to < 6mm	395	55	505	70
Steel > 1.5mm to < 3mm	325	45	395	55
Steel < 1.5	250	35	325	45
Castings > 6mm	505	70	575	80
Castings < 6mm	430	43	505	70

ISO 1461 coating minimum masses (related to thickness) on sample which are centrifuged.

Article and its Thickness mm	(a) Local coating (m/A) (minimum)		(b) Mean coating (m/A) (minimum)	
	g/m ²	µm	g/m ²	µm
Articles with threads				
>20mm diameter	325	45	395	55
> 6 – < 20mm diameter	250	35	325	45
< 6mm diameter	145	20	180	25
Other articles (including coating)				
< 3mm	325	45	395	55
< 3mm	250	35	325	45

(a) Local coating mass: The value of coating mass obtained from a single gravimetric test.

(b) Mean coating mass: The average value of the coating determined either by using a control sample selected according to clause 5 with tests according to ISO 1460 or by conversion of the mean coating thickness. (The average value of the local thickness either on one large article or on all the articles in the control sample).

(c) Sampling: A control sample for thickness testing shall be taken randomly from each inspection lot selected for testing. The minimum number of articles from each inspection lot to form the control sample shall be according to the following table.

Control sample size related to lot size

Acceptance inspection shall be undertaken before the products leave the hot dip galvanizer's factory, unless otherwise specified at the time of ordering by the purchaser.

Number of articles in the lot	Minimum number or articles in the control sample
1 to 3	All
4 to 500	3
501 to 1200	5
1201 to 3200	8
3201 to 10000	13
> 10000	20



Finishes

Plascoat PPA571

PPA571 is a long lasting and tough coating for exterior application. It is Halogen Free, low smoke during combustion and non toxic. Technical specification shown as below.

Appearance		Smooth
Coverage	(100% efficiency)	min. 250 micron
Tensile Strength	ISO 527	12 MPa
Elongation at Break	ISO 527	800%
Hardness	Shore A	95
	Shore D	44
Electrical Dielectric Strength	IEC 243 (1988)	14.5 KV/mm
Breakdown Voltage	IEC 243 (1988)	40 rms KV
Salt Spray	ISO 7253 (ASTN B117)	Result after 1000 hours
	Steel	– Scribed Loss of adhesion less than 10mm from scribe.
	– Unscribed	Under film corrosion 2-3mm, No loss of adhesion
Chemical Resistance	Dilute Acids & Alkali	Good
Adhesion	PSL. TM/9	A-1
Weathering	QUV ISO 4892	2000 hours - No significant change in colour or loss of gloss
	Florida 45° facing South	3 years – No significant change in colour or loss of gloss
Burning characteristics		
– Ignitability	BS476: Pt5: 1979	P-not easily ignitable
– Surface spread of flame	BS476: Pt7: 1979	Class 1
– Fire Propagation	BS476: Pt6: 1984	I = 0.2

Epoxy Powder Coated

Epoxy Powder Coating is a thermoset type powder coatings generally for interior use, providing very good decorative properties with excellent chemical resistance. These coatings are not ideally suited to prolonged exterior exposure or for use at elevated temperatures. They are available in a range of glosses and colours and in a variety of texture finishes.

Polyester Powder Coated

Polyester Powder Coating is ideal for use on metallic building components such as aluminum profiles, sections and sheet, agricultural equipment, garden furniture and leisure products etc. The primary characteristic of polyester powder coating is its supreme colour and gloss-retention on external exposure.

Other Finishes

Upon client request, stainless steel 304, 316 and Glass Reinforced Plastic material (GRP) will be supplied.



Address G/F, Lung Shing Factory Bldg.,
148 Texaco Road
Tsuen Wan, N.T.,
Hong Kong

Phone (852) 2407 8222

Fax (852) 2407 3000

Email cs@ktp-hk.com

Website www.ktp-hk.com

